

Schäfer + Peters GmbH



EDELSTAHL®
**Rost
frei**
INOX
STAINLESS STEEL

BIOGAS



Table of contents

Anchor coach screws, type 41/41	23
Support bracket MSK, type 1 - 28/28	18
Support bracket MSK, type 4 - 41/41	22
Support bracket MSK, type 5 - 41/41 with crossbeam	22
Eye bolt DIN 444	38
Concrete bolt BS	29
Self-drilling screws DIN 7504 with fillister head	54
Self-drilling screws DIN 7504 with hexagon head and collar	52
Self-drilling screws DIN 7504 with hexagon head and washer	51
Self-drilling screws DIN 7504 with countersunk head	53
Wedge anchor BOZ for cracked and non-cracked concrete	28
Sealing washers with EPDM coating	59
Wire cable clips	7
Stainless steel wire cable in accordance with DIN 3055 medium soft 7x7 (at 1570 N/mm ²)	6
Stainless steel wire cable in accordance with DIN 3060 soft 7x7 (at 1570 N/mm ²)	6
Facade construction screw with EPDM seal / washers 16mm in diameter	48
Spring cotter (double version)	26
Cup square bolt DIN 603	37
Wing nut DIN 315	57
Screw sockets - round with continuous female thread	58
Screw sockets - hex with continuous female thread	57
Threaded rods DIN 976	36
T-head bolts MZS 41/22	24
Hammerhead screws, type 28/15	19
TCS countersunk - timber construction screw with inner multi-toothing	44
TCS countersunk - timber construction screw with Pozidrive	47
TCS - chipboard screw with round head	46
TCS flat head - timber construction screw with cutting score and inner multi-toothing	45
Cap nut DIN 1587	56
Carabiner	10
Square washers	60
Cable eye stiffeners	10
Chains (with short links) DIN 766	13
Chains (with long links) DIN 763	12
Spare chain link	13
Classic console-mounted winch	5
Premium console-mounted winch	4
Fillister head screw ISO 7380 with flange	41
Fillister head screw ISO 7380 without flange	40

Mounting profile system 28	16
Mounting profile system 41	20
Eyelet bolts with wooden thread	42
Eyelet bolts with metric thread	42
Profile base system 28	17
Profile base system 41	21
Square tubing bracket, without nuts	25
Frame bracket system 28	17
Frame bracket system 41	21
Lifting eye nut DIN 582	39
Eyebolts DIN 580	39
Shackle (welded)	9
Shackle (short)	12
Shackle (long)	9
Steel U-bolt DIN 3570 shape A, without nuts	24
Hinge	14
Hinge, heavy-duty version	14
Rail nut, type 41/41	23
Hose clips DIN 3017	26
Hexagon head wood screws DIN 571	43
Hexagonal nuts DIN 934	55
Hexagonal nuts DIN 985 with non-metallic clamping part	56
Hexagonal nuts DIN 6923 with flange and locking teeth	55
Hexagonal screws DIN 931 with shoulder	30
Hexagonal screws DIN 933 with full thread	32
Countersunk screws with hexagonal socket DIN 7991	35
Special parts	15
Turnbuckles	11
Split pins DIN 94	27
Hanger bolts with hexagon head	50
Hanger bolts, standard	49
U-bolts	25
Washers DIN 125 shape A (without bevel)	58
Washers DIN 9021	59
Swivel (lift eye - lift eye)	7
Swivel shackle (lift eye - fork)	8
Swivel shackle (fork - fork)	8
Socket cap screws DIN 912 with hexagonal socket	34

Premium console-mounted winch

Material: stainless steel A2

Tensile force 650 kg and 900 kg

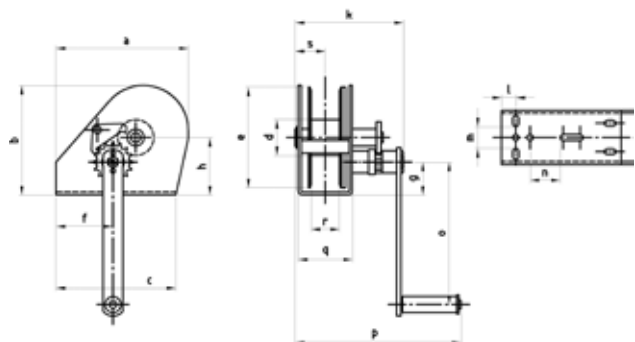

► Features and handling:

Stainless steel version (1.4301) for increased corrosion requirements
Light spur gear unit for high efficiency and convenient operation
The load pressure brake fitted securely holds the load in any position. This effectively prevents unintended lowering of the load
Quick and easy console attachment

Technical data

Model	Tensile load, 1 position in kg	Tensile load, top position in kg	Cable diameter in mm	Cable capacity, 1 position in m	Total cable capacity in m	Lift per crank revolution in mm	Crank force needed in daN	Weight not including cable in kg	Item number
Type SW K - LB 650	650	290	6*	1	20	55	22	7.6	95982650
Type SW K - LB 900	900	320	7*	1	26	45	24	12.1	95982900

* This is the recommended cable diameter. Other diameters can be selected.

Dimensions (in mm), premium model

Model	A mm	B mm	C mm	Dia. D mm	Dia. E mm	F mm	G mm	H mm	K mm	L mm	M mm	N mm	O mm	P mm	Q mm	R mm	S mm
Type SW K - LB 650	232	192	210	63.5	183	100	58	100	190	25	38	-	250	291	95	50	55
Type SW K - LB 900	273	266	240	63.5	255	78	75	138	190	35	30	53	250	291	95	50	55

Classic console-mounted winch

Material: stainless steel A2
Tensile force 270 kg and 540 kg

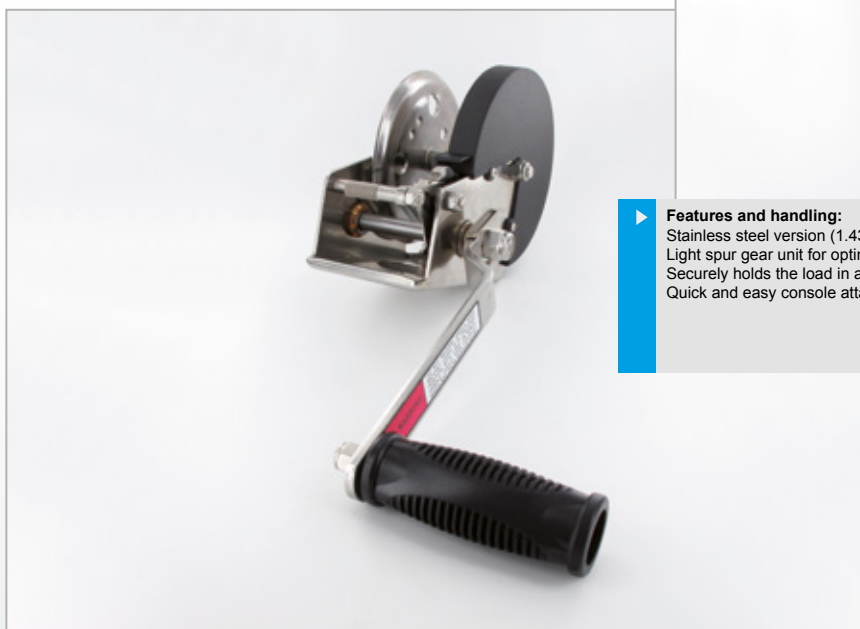
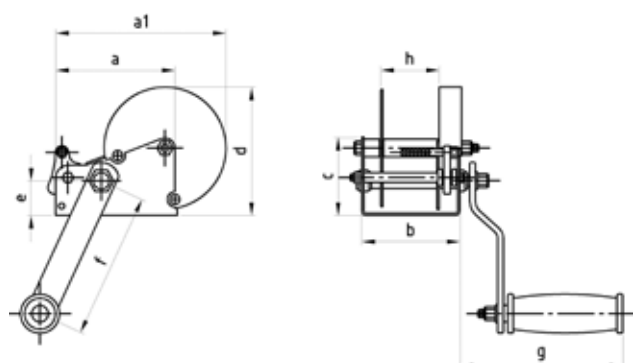

► **Features and handling:**
 Stainless steel version (1.4301) for increased corrosion requirements
 Light spur gear unit for optimum operation
 Securely holds the load in any position. This prevents unintended lowering of the load
 Quick and easy console attachment

Technical data

Model	Tensile load in kg	Cable diameter in mm	Cable capacity, 1 position in m	Total cable capacity in m	Lift per crank revolution in mm	Crank force needed in daN	Weight not including cable in kg	Item number
Type SP 270	270	6*	1	18	55	22	7.6	95972270
Type SP 540	540	7*	1	23	45	24	12.1	95972540

* This is the recommended cable diameter. Other diameters can be selected.

Dimensions (in mm), CLASSIC model

Model	A mm	A1 mm	B mm	C mm	Dia. D mm	E mm	F mm	G mm	H mm
Type SP 270	110	140	85	70	110	45	180	125	51
Type SP 540	175	110	90	95	220	60	220	130	60

Stainless steel wire cable in accordance with DIN 3055 medium soft 7x7 (at 1570 N/mm²)

Material: stainless steel A4

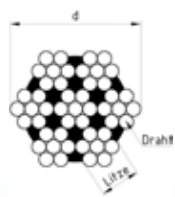

Wire
Strand



Technical data

d	Item no.	Weight kg/m	Theor. breaking load/kN	Min. breaking load/kN	Unit in m
---	----------	-------------	-------------------------	-----------------------	-----------

Other diameters/materials on request

Stainless steel wire cable in accordance with DIN 3060 soft 7x7 (at 1570 N/mm²)

Material: stainless steel A4

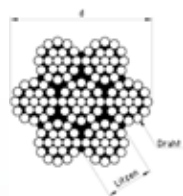

Technical data

d	Item number	Weight kg/m	Theor. breaking load/kN	Min. breaking load/kN	Unit in m
---	-------------	-------------	-------------------------	-----------------------	-----------

Other diameters/materials on request

Wire cable clips

Material: stainless steel A4

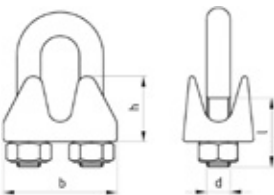

Technical data						
Wire diameter	Item no.	d	l	h	b	Unit

Other diameters/materials on request

Swivel (lift eye - lift eye)

Material: stainless steel A4

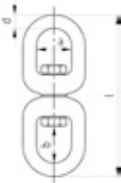

Technical data					
d	Item no. A4	l	b	a	Unit

Other diameters/materials on request

Swivel shackle (lift eye - fork)

Material: stainless steel A4

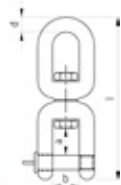

Technical data

Dia.	Item no. A4	l	b	a	Unit
------	-------------	---	---	---	------

Other diameters/materials on request

Swivel shackle (fork - fork)

Material: stainless steel A4

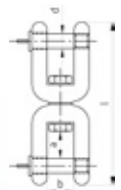

Technical data

Dia.	Item no. A4	l	b	a	Unit
------	-------------	---	---	---	------

Other diameters/materials on request

Shackle (long)

Material: stainless steel A4

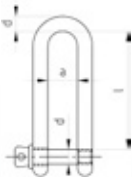

Technical data					
Dia.	Item no. A4	a	l	Unit	Unit

Other diameters/materials on request

Shackle (welded)

Material: stainless steel A4

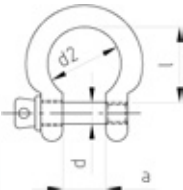

Technical data					
Dia.	Item no. A4	a	d2	l	Unit

Other diameters/materials on request

Cable eye stiffeners

Material: stainless steel A4

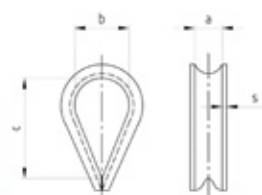

Technical data

Wire diameter	Item no.	a	b	c	Unit
---------------	----------	---	---	---	------

Other diameters/materials on request

Carabiner

Material: stainless steel A4

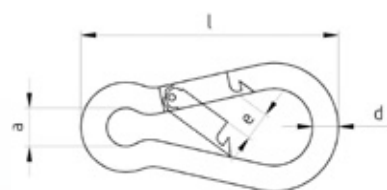

Technical data

d	L	Item no.	a	e	Unit
---	---	----------	---	---	------

Other diameters/materials on request

Turnbuckles

Material: stainless steel A4

Version: eyelet - eyelet

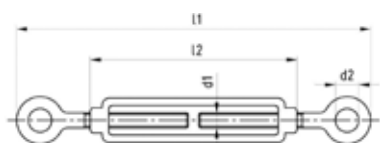

Version: hook - hook

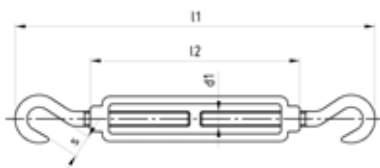

Version: hook - eyelet

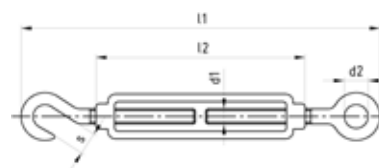

Technical data

d	Item no.	l1	l2	d2	Version	Unit
M 5	90724A5	120	70	8	Eyelet - eyelet	1
M 6	90724A6	160	90	10	Eyelet - eyelet	1
M 8	90724A8	200	120	14	Eyelet - eyelet	1
M 10	90724A10	240	150	16	Eyelet - eyelet	1
M 12	90724A12	300	200	18	Eyelet - eyelet	1
M 5	90724B5	120	70	-	Hook - hook	1
M 6	90724B6	160	90	-	Hook - hook	1
M 8	90724B8	200	120	-	Hook - hook	1
M 10	90724B10	240	150	-	Hook - hook	1
M 12	90724B12	300	200	-	Hook - hook	1
M 5	90724C5	120	70	8	Eyelet - hook	1
M 6	90724C6	160	90	10	Eyelet - hook	1
M 8	90724C8	200	120	14	Eyelet - hook	1
M 10	90724C10	240	150	16	Eyelet - hook	1
M 12	90724C12	300	200	18	Eyelet - hook	1

Shackle (short)

Material: stainless steel A4

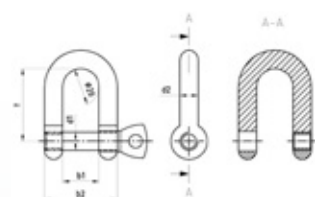

Technical data

A in mm	L in mm	Item no.	B in mm	D in mm	Unit
---------	---------	----------	---------	---------	------

Other diameters/materials on request

Chains (with long links) DIN 763

Material: stainless steel A4

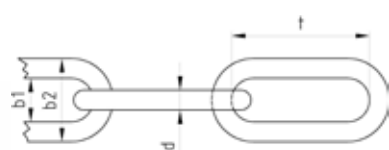

Technical data

d	Item no. A4	t	b1	b2	Unit
---	-------------	---	----	----	------

Other diameters/materials on request

Chains (with short links) DIN 766

Material: stainless steel A4

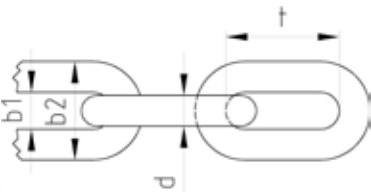

Technical data					
d	Item no. A4	t	b1	b2	Unit

Other diameters/materials on request

Spare chain link

Material: stainless steel A4

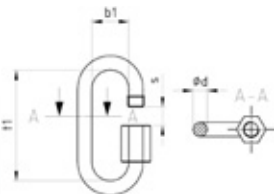

Technical data					
d	t1	Item no.	b1	s	Unit

Other diameters/materials on request

Hinge

Material: stainless steel A4

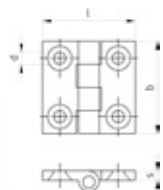

Technical data

Item no. A4	L	B	S	d	Unit
-------------	---	---	---	---	------

Other diameters/materials on request

Hinge, heavy-duty version

Material: stainless steel A2

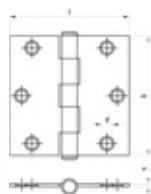

Technical data

Item no. A4	L	B	S	d	Unit
-------------	---	---	---	---	------

Other diameters/materials on request

Special parts

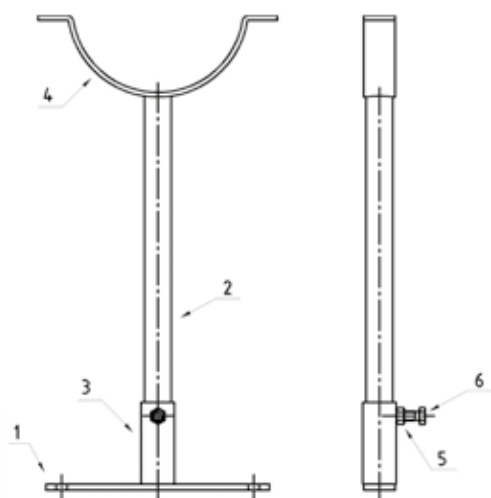

We would be happy to source the special parts you need to meet your requirements.

We can work to your drawings.



Mounting profile system 28

Version: perforated

Material: stainless steel A2 / A4

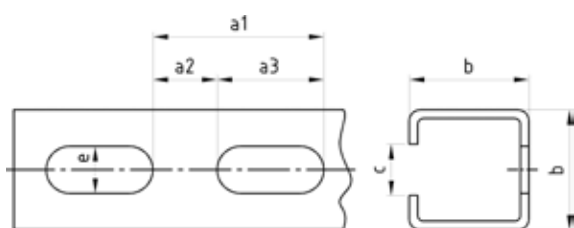

Technical data

Profile	Length	Version	Weight in kg/m	Cross-section values					Max. perm. point load bearing capacity								Item no.	Unit
				Profile cross-section	Torque of inertia		Resistance torque				F (kN)			Q (kN)				
					A (cm ²)	Jy (cm ⁴)	Jz (cm ⁴)	Wy (cm ³)	Wz (cm ³)	kN	cm	0.5 m	1.0 m	1.5 m	0.5 m	1.0 m		
28/28	3 metres	A2	1.370	1.750	1.593	2.411	1.124	1.722	3.171	27	1.861	0.930	0.425	3.652	1.559	0.680	955022828 3000	1
28/28	3 metres	A4	1.370	1.750	1.593	2.411	1.124	1.722	3.456	27	2.028	1.014	0.463	3.981	1.699	0.741	955042828 3000	1

Technical data

Profile	e	ab	a1	a2	b	c	0.5 m	1.0 m	1.5 m	0.5 m	1.0 m	1.5 m
							f (mm)			f (mm)		

Other diameters/materials on request

Profile base system 28

Material: stainless steel A4

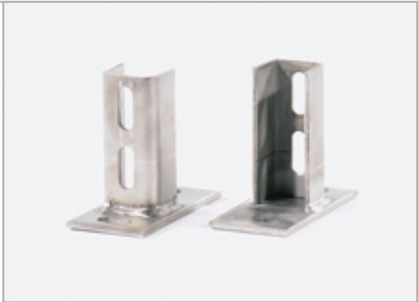
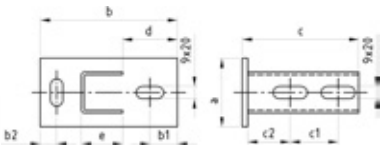

Technical data										
Type	Dimensions (in mm)									Item no.
	a	b	b1	b2	c	c1	c2	d	e	

Other diameters/materials on request

Frame bracket system 28

Material: stainless steel A4

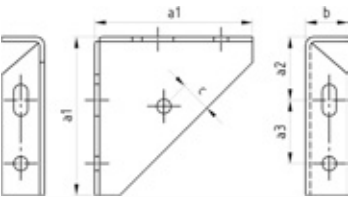

Technical data							
Type	Dimensions (in mm)					Item no.	Unit
	a1	a2	a3	b	s		

Other diameters/materials on request

Support bracket MSK, type 1 - 28/28

Material: stainless steel A4

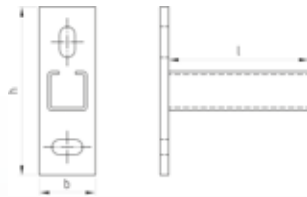

Technical data

l	h	b	Load bearing capacity values				Item no.	Unit
			F1 (kN)	F1 (kN)	F2 (kN)	F2 (kN)		

Other diameters/materials on request

- ▶ A trusted and innovative partner since 1982.
- ▶ With over 30 000 high-quality fastening products, we are a market leader in stainless steel fasteners.
- ▶ Constant product range expansion –in response to market developments and customer requirements.
- ▶ We set new standards in the areas of quality management and state of the art logistics.
- ▶ Our readiness to perform, warehouse capacity and an experienced team are at your service.
- ▶ Fast delivery is a matter of course with us.
- ▶ Our company is DIN EN ISO 9001: 2008 certified.
- ▶ We combine quality and service – for connections that are made to last.



Hammerhead screws, type 28/15

Version: type 28/15
Material: stainless steel A2 / A4

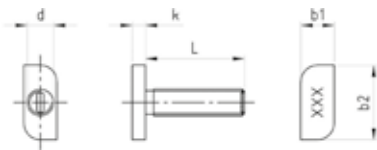

Technical data							
Dia.	l/mm	Item no. A2	Item no. A4	l= head length	b= head width	h= height	Unit

Other diameters/materials on request

Mounting profile system 41

Version: perforated

Material: stainless steel A2 / A4

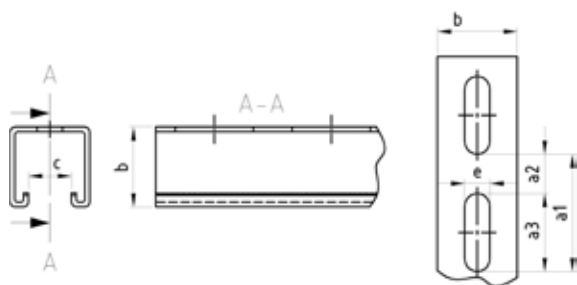

Technical data

Profile	Length	Version	Weight in kg/m	Cross-section values					Max. perm. point load bearing capacity								Item no.	Unit
				Profile cross-section	Torque of inertia		Resistance torque				F (kN)			Q (kN)				
					A (cm ²)	Jy (cm ⁴)	Jz (cm ⁴)	Wy (cm ³)	Wz (cm ³)	kN	cm	0.5 m	1.0 m	1.5 m	0.5 m	1.0 m		
41/41	3 metres	A4	2.540	.	6.077	9.020	2.866	4.400	8.649	27	5.196	2.622	1.742	9.914	5.179	2.884	956044141 3000	1

Technical data

Profile												
	e	a3	a1	a2	b	c	0.5 m	1.0 m	1.5 m	0.5 m	1.0 m	1.5 m
							f (mm)			f (mm)		
41/41	13	40	60	20	41	22	0.634	2.554	5.795	0.793	3.185	7.212

Other diameters/materials on request

Profile base system 41

Material: stainless steel A4

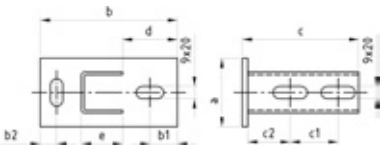

Technical data

Type	Dimensions (in mm)									Item no.	Unit
	a	b	b1	b2	c	c1	c2	d	e		

Other diameters/materials on request

Frame bracket system 41

Material: stainless steel A4

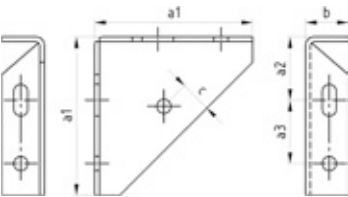

Technical data

Type	Dimensions (in mm)					Item no.	Unit
	a1	a2	a3	b	c		

Other diameters/materials on request

Support bracket MSK, type 4 - 41/41

Material: stainless steel A4

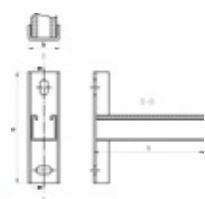

Technical data

l	h	b	Load bearing capacity values				Item no.	Unit
			F1 (kN)	F1 (kN)	F2 (kN)	F2 (kN)		

Other diameters/materials on request

Support bracket MSK, type 5 - 41/41 with crossbeam

Material: stainless steel A4

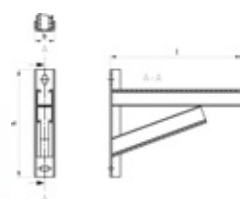

Technical data

l	h	b	Load bearing capacity values				Item number	Unit
			F1 (kN)	F1 (kN)	F2 (kN)	F2 (kN)		

Other diameters/materials on request

Anchor coach screws, type 41/41

Version: type 41/41 with partial toothing

Material: stainless steel A2 / A4

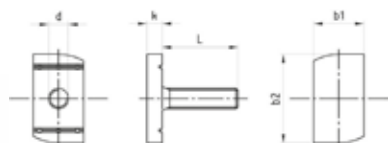

Technical data

Dia.	l/mm	Item no. A2	Item no. A4	l= head length	b= head width	h= height	Unit
M 8	30	909928 30	909948 30	34.5	19.5	6	100
M 10	30	9099210 30	9099410 30	34.5	19.5	6	100
For profiles 41/21 and 41/41							

Other diameters/materials on request

Rail nuts, type 41/41

Version: type 41/41 with partial toothing & fixing aid

Material: stainless steel A2 / A4

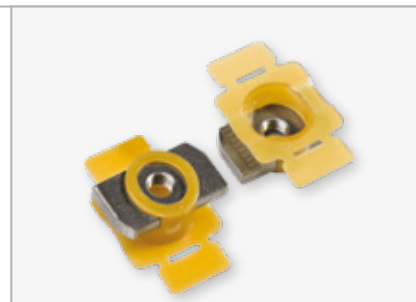
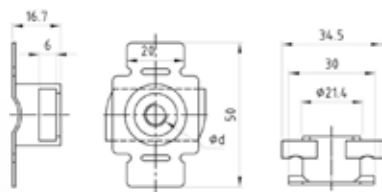

Technical data

Dia.	Item no. A2	Item no. A4	l= head length	b= head width	h= height	Unit
M 8	909928F	909948F	34.5	19.5	6	100
For profiles 41/21 and 41/41						

Other diameters/materials on request

T-head bolts MZS 41/22

with toothing in accordance with DIN ISO 3506

Material: stainless steel A4-50

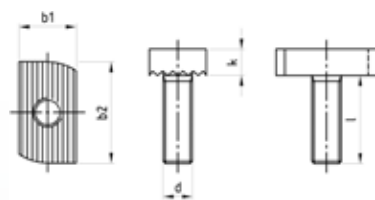

Technical data

d	l/mm	Item no.	k	b1	b2	Description	Tightening torque	Recommended load kN	Unit
M 10	50	959545010 50	9	19.5	34.5	Art.9595 T-head bolt A4-50 41/22 M10X50	15	6.4	100
M 12	35	959545012 35	9	19.5	34.5	Art.9595 T-head bolt A4-50 41/22 M12X35	25	9.3	100
M 12	50	959545012 50	9	19.5	34.5	Art.9595 T-head bolt A4-50 41/22 M12X50	25	9.3	100
M16	50	959545016 50	9	19.5	34.5	Art.9595 T-head bolt A4-50 41/22 M16X50	60	17.3	100

Other diameters/materials on request

Steel U-bolt DIN 3570 shape A, without nuts

Material: stainless steel A4

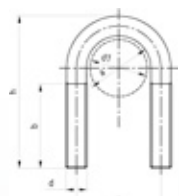

Technical data

d3	Item no. A4	h	b	e	a	To be used with tubing with the following nominal widths	Unit
						d1 mm Imperial	

Other diameters/materials on request

Square tubing bracket, without nuts

Material: stainless steel A4

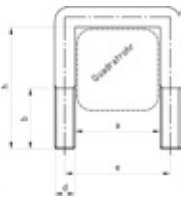

Square
tubing



Technical data							
d	Item number	for tubing diameter in mm	a	e	b	h	Unit

Other diameters/materials on request

U-bolts

Material: stainless steel A2

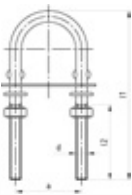

Technical data					
Thread d	Item no. A2	l1	a	l2	Unit

Other diameters/materials on request

Spring cotter (double version)

Material: stainless steel A4

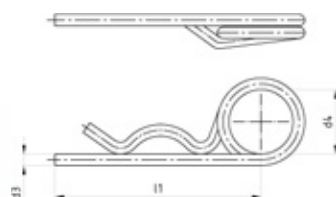

Technical data

Nominal hole diameter	Item no.	Wire diameter d3	L1	d4	Unit
-----------------------	----------	------------------	----	----	------

Other diameters/materials on request

Hose clips DIN 3017

Material: stainless steel A2 / A4

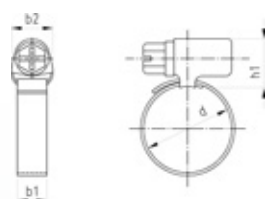

Technical data

d = tensioning range	Item no. A2	Item no. A4	b1 =band width	Unit
----------------------	-------------	-------------	----------------	------

Other diameters/materials on request

Split pins DIN 94

Material: stainless steel A4

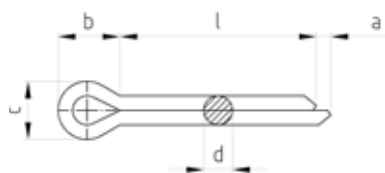

Technical data

d	2.0	2.5	3.2	4.0	5.0	6.3	8.0
---	-----	-----	-----	-----	-----	-----	-----

Other diameters/materials on request

Wedge anchor BOZ for cracked and non-cracked concrete

Material: stainless steel A4

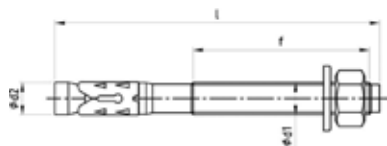

Technical data

d	Total length	Clamping strength	Effective anchoring depth	Drill hole depth h1	Hole diameter	Perm. loads (tension) C 20/25 in kN, cracked concrete	Perm. loads (tension)) C 20/25 in kN, non-cracked concrete	Minimum centre distance	Minimum edge distance	Item number	Item designation	Drive	Unit
---	--------------	-------------------	---------------------------	---------------------	---------------	---	---	-------------------------	-----------------------	-------------	------------------	-------	------

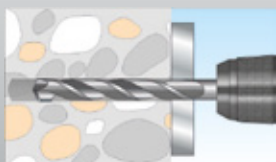

Other diameters/materials on request

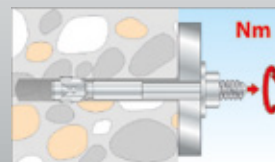
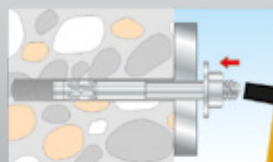
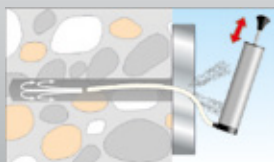

Concrete bolt BS

For cracked and non-cracked concrete (option 1)



Version: For direct screwing into concrete without dowel

Carbide-tipped bolt available in hex, countersunk and anchor bolt versions

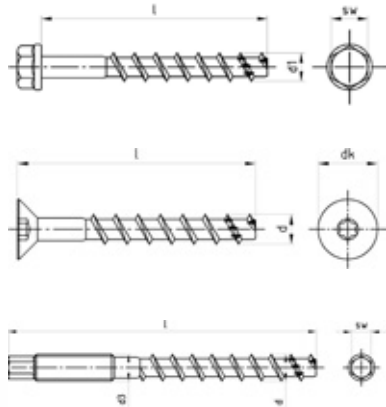
Material: stainless steel A4



Technical data

Material: austenitic stainless steel A41.4401	Bolts / d	Total length	Item no.	Clamping strength	Minimum anchoring depth	Drill hole depth	Hole diameter	Perm. loads (tension) C 20/25 in kN	cracked concrete	non-cracked concrete	Char. centre distance (mm)	Char. edge distance (mm)	Minimum centre distance (mm)	Minimum edge distance (mm)	Min. component thickness (mm)	Drive	Unit
SP concrete bolt, hex																	
SPBS-A4 10.0x15/80 WAF 13	10	80	9001410 15/80	15	65	75	8	4.2	5.8	141	70.5	50	50	120	WAF 13	50	
SPBS-A4 12.0x15/100 WAF 17	12	100	9001412 15/100	15	85	95	10	6.2	8.7	192	96	70	70	130	WAF 17	50	
																	
SP concrete bolt, countersunk head																	
SPBS-A4 10x15/80 SeKo	10	80	90014010 15/80	15	65	75	8	4.2	5.8	141	70.5	50	50	120	TX40	50	
																	
SP concrete anchor bolt																	
SPBS-A4 12x35/140 M12 WAF 9	12/M12	140	9001412 35/140	35	85	95	10	6.2	8.7	192	96	70	70	130	WAF 9	50	
SPBS-A4 12x55/160 M12 WAF 9	12/M12	160	9001412 55/160	55	85	95	10	6.2	8.7	192	96	70	70	130	WAF 9	50	
																	

Hexagonal screws DIN 931 with shoulder

Material: stainless steel A2 / A4

Available dimensions:

Diameters in range M 5 to M 45 in various lengths from 25 mm to 600 mm

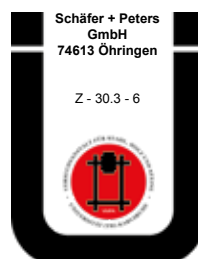
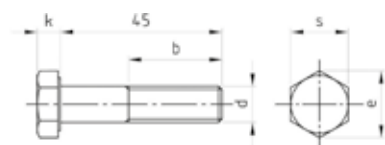

Technical data

d	l/mm	b/mm	Item no. A2	Item no. A4	k = height of head	Drive	Unit
---	------	------	-------------	-------------	--------------------	-------	------

Other diameters/materials on request

Hexagonal screws DIN 931 with shoulder

Technical data						
d	l/mm	b/mm	Item no. A2	Item no. A4	k = height of head	Drive
Unit						

Other diameters/materials on request

Hexagonal screws DIN 933 with full thread

Material: stainless steel A2 / A4

Available dimensions:

**Diameters in range M 5 to M 45 in various lengths
from 25 mm to 600 mm**

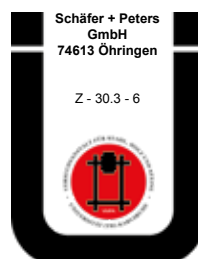
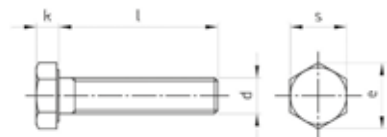

Technical data

d	l/mm	Item no. A2	Item no. A4	k = height of head	Drive	Unit
---	------	-------------	-------------	--------------------	-------	------

Other diameters/materials on request

Hexagonal screws DIN 933 with full thread

Technical data						
d	l/mm	Item no. A2	Item no. A4	k = height of head	Drive	Unit

Other diameters/materials on request

Socket cap screws DIN 912 with hexagonal socket

Material: stainless steel A2 / A4

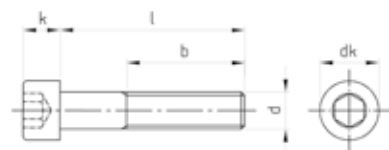

Technical data

d	l/mm	b/mm	Item no. A2	Item no. A4	k = height of head	Drive	Unit
---	------	------	-------------	-------------	--------------------	-------	------

Other diameters/materials on request

Countersunk screws with hexagonal socket DIN 7991

Material: stainless steel A2 / A4

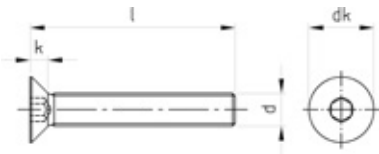

Technical data							
d	l/mm	Item no. A2	Item no. A4	dk	k = height of head	Drive	Unit

Other diameters/materials on request

Threaded rods DIN 976

Material: stainless steel A2 / A4



Technical data				
d	l/mm	Item no. A2	Item no. A4	Unit

Other diameters/materials on request

Cup square bolt DIN 603

Material: stainless steel A2 / A4

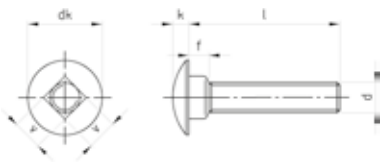

Technical data						
d	l/mm	Item no. A2	Item no. A4	k	dk	Unit

Other diameters/materials on request

Eye bolt DIN 444

Material: stainless steel A2 / A4

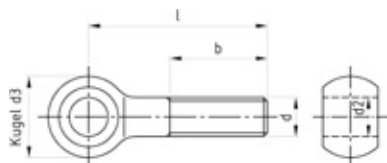

Technical data

d	l/mm	b/mm	Item no. A2	Item no. A4	d2	Ball d3	Unit
---	------	------	-------------	-------------	----	---------	------

Other diameters/materials on request

Eyebolts DIN 580

Material: stainless steel A2 / A4
Version: forged

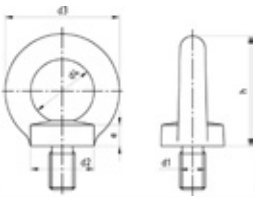

Technical data									
d	l/mm	Item no. A2	Item no. A4	d2	d3	d4	h	e	Unit

Other diameters/materials on request

Lifting eye nut DIN 582

Material: stainless steel A2 / A4
Version: forged

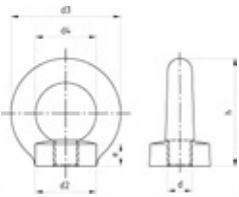

Technical data								
d	Item no. A2	Item no. A4	d2	d3	d4	h	e	Unit

Other diameters/materials on request

Fillister head screw ISO 7380 without flange

Hexagonal socket drive and inner multi-toothing

Material: stainless steel A2 / A4

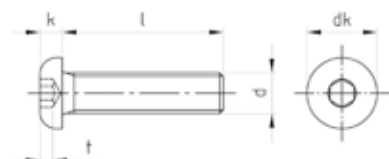

Technical data

d	l/mm	Item no. A2	Item no. A4	Drive	Item no.	Drive	dk = head diameter	k = height of head	Unit
---	------	-------------	-------------	-------	----------	-------	--------------------	--------------------	------

Other diameters/materials on request

Fillister head screw ISO 7380 with flange

Version: with flange - large head diameter, hexagonal socket drive and inner multi-tooththing
Material: stainless steel A2 / A4

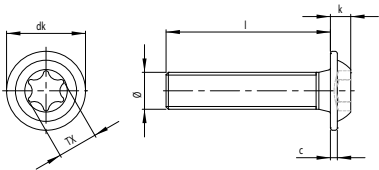

Technical data									
d	l/mm	Item no. A2	Item no. A4	Drive	Item no.	Drive	dk = head diameter	k = height of head	Unit

Other diameters/materials on request

Eyelet bolts with metric thread

Material: stainless steel A2

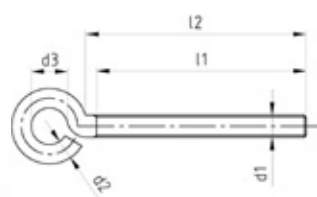

Technical data

d	L	Item no.	L1	d2	d3	Unit
---	---	----------	----	----	----	------

Other diameters/materials on request

Eyelet bolts with wooden thread

Material: stainless steel A2

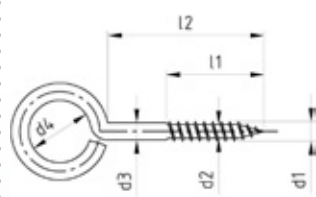

Technical data

d	L	Item no.	L1	d2	d3	S	Unit
---	---	----------	----	----	----	---	------

Other diameters/materials on request

Hexagon head wood screws DIN 571

Material: stainless steel A2 / A4

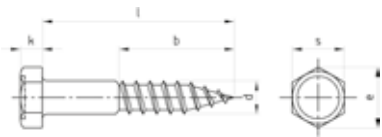

Technical data							
d	l/mm	b/mm	Item no. A2	Item no. A4	k = height of head	Drive	Unit

Other diameters/materials on request

TCS countersunk - timber construction screw with inner multi-toothing

Version: smooth coating
Material: stainless steel A2 / A4

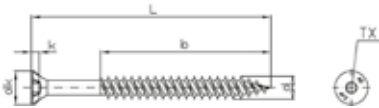

Technical data								
d	l/mm	b/mm	Item no. A2	Item no. A4	k	dk = head dia- meter	Drive	Unit

Other diameters/materials on request

TCS flat head - timber construction screw with cutting score and inner multi-toothing

Head diameter: 15 mm / 19 mm
Version: smooth coating
Material: stainless steel A2

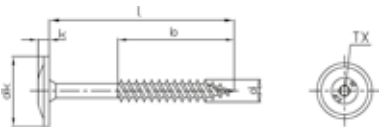

Technical data							
d	l/mm	b/mm	Item no.	k	dk = head diameter	Drive	Unit

Other diameters/materials on request

TCS - chipboard screw with round head

Version: smooth coating

Material: stainless steel A2 / A4

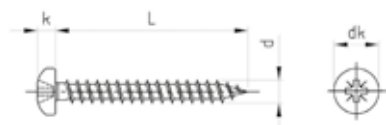

Technical data

d	l/mm	b/mm	Item no.	k	dk = head diameter	Drive	Unit
---	------	------	----------	---	--------------------	-------	------

TCS countersunk - timber construction screw with Pozidrive

Version: smooth coating
Material: stainless steel A2 / A4

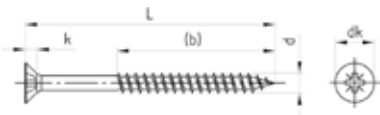

Technical data								
d	l/mm	b/mm	Item no. A2	Item no. A4	k	dk = head dia- meter	Drive	Unit

Facade construction screw with EPDM seal / washers, diameter 16mm

Version: washer diameter 16 mm

Shape A (with tip)

Shape BZ (with dog point)

Material: stainless steel A2

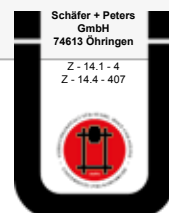
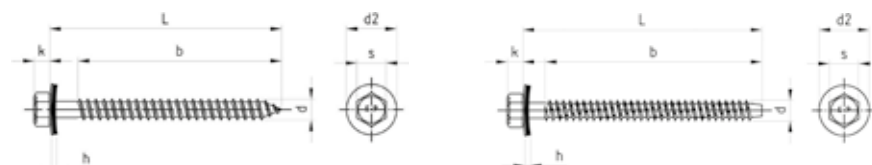

Technical data

d	l/mm	d1 washer diameter	Item no.	Shape	Drive	Unit
---	------	--------------------	----------	-------	-------	------

Other washer diameters available from stock on request.

Hanger bolts, standard

Version: standard,
hex between threads
Material: stainless steel A2

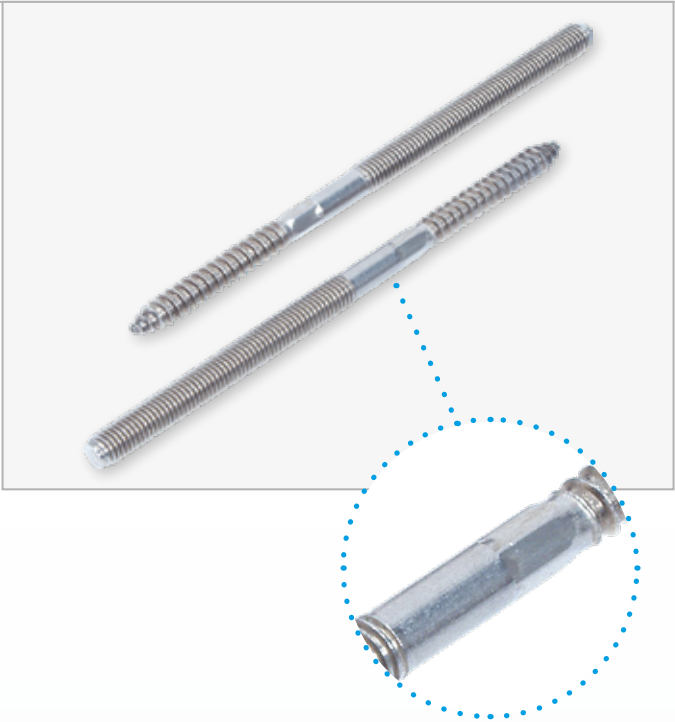
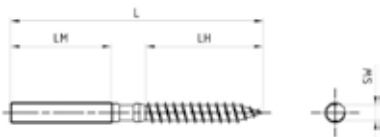

Technical data						
d	l/mm	Item no.	LM	LW	Drive	Unit

Other diameters/materials on request

Hanger bolts with hexagon head

Version: with hex drive WAF 7 (M10) and hex drive WAF 9 (M12)
Material: stainless steel A2

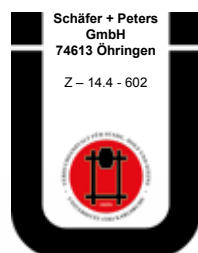
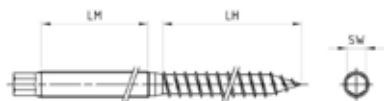

Technical data

d	l/mm	Item no.	LM	LW	Drive	Unit
---	------	----------	----	----	-------	------

Other diameters/materials on request

Self-drilling screws DIN 7504 with hexagon head and washer

Version: shape KO (with hexagon head and collar and fitted 16 mm diameter A2/EPDM sealing washer)
Use: for soft metals e.g. aluminium
Material: stainless steel A2

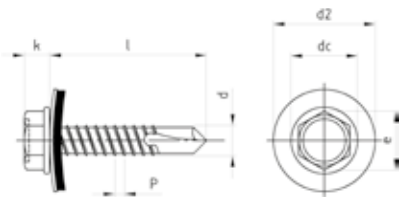

Technical data					
d	l/mm	Item no.	Drilling range	Drive	Unit

Bi-metal screws available from stock on request.

Self-drilling screws DIN 7504 with hexagon head and collar

Version: shape K (with hexagon head and collar)

Use: for soft metals e.g. aluminium

Material: stainless steel A2

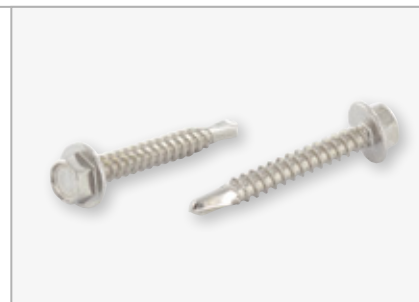
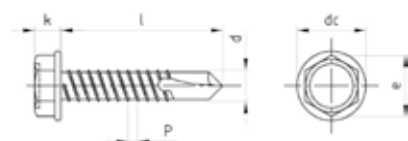

Technical data

d	l/mm	Item no.	Drilling range	Drive	Unit
---	------	----------	----------------	-------	------

Dia.	l/mm	Item no.	Drilling range	Drive	Unit
------	------	----------	----------------	-------	------

Other diameters/materials on request

Self-drilling screws DIN 7504 with countersunk head

Version: shape O (countersunk head)
Drive: Phillips / Pozidrive / inner multi-toothing
Use: for soft metals e.g. aluminium
Material: stainless steel A2

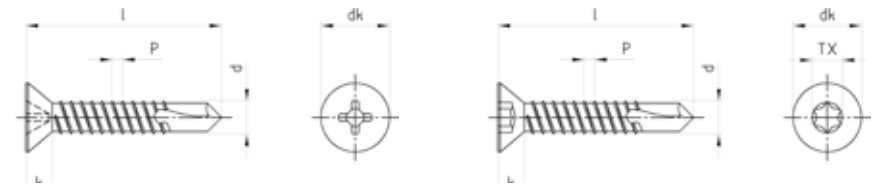

Technical data									
d	l/mm	Item no.	Drive	Item no.	Drive	Item no.	Drive	Drilling range	Unit

Special solutions for carbides on request
Other diameters/materials on request

Self-drilling screws DIN 7504 with fillister head

Version: shape M (fillister head)

Drive: Phillips / Pozidrive / inner multi-toothing

Use: for soft metals e.g. aluminium

Material: stainless steel A2

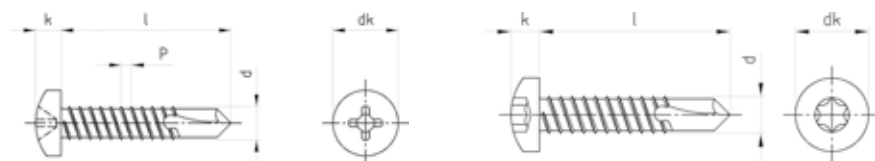

Technical data

d	l/mm	Item no.	Drive	Item no.	Drive	Item no.	Drive	Drilling range	Unit
---	------	----------	-------	----------	-------	----------	-------	----------------	------

Other diameters/materials on request

Hex nuts DIN 934

Material: stainless steel A2 / A4

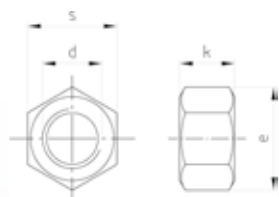

Technical data

d	Item no. A2	Item no. A4	h = height	Drive	Unit
---	-------------	-------------	------------	-------	------

Other diameters/materials on request

Hex nuts DIN 6923 with flange and locking teeth

Material: stainless steel A2 / A4

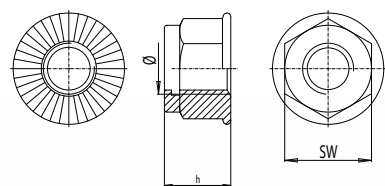

Technical data

d	Item no. A2	Item no. A4	h = height	dk	Drive	Unit
---	-------------	-------------	------------	----	-------	------

Other diameters/materials on request

Cap nut DIN 1587

Material: stainless steel A2 / A4

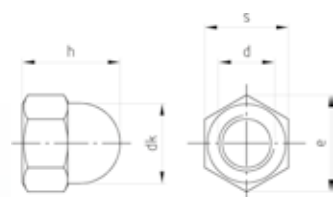

Technical data

d	Item no. A2	Item no. A4	e	dk	m	h = height	Drive	Unit
---	-------------	-------------	---	----	---	------------	-------	------

Other diameters/materials on request

Hexagonal nuts DIN 985 with non-metallic clamping part

Version: compact shape

Material: stainless steel A2 / A4

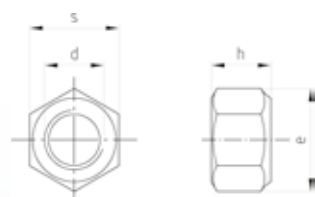

Technical data

d	Item no. A2	Item no. A4	h = height	Drive	Unit
---	-------------	-------------	------------	-------	------

Other diameters/materials on request

Wing nut DIN 315

Version: forged shape
Material: stainless steel A2 / A4

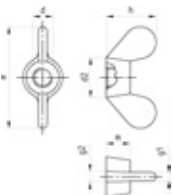

Technical data								
d	Item no. A2	Item no. A4	D	e	g	h	m	Width
								Unit

Other diameters/materials on request

Screw sockets - hex with continuous female thread

Version: hex
Material: stainless steel A2 / A4

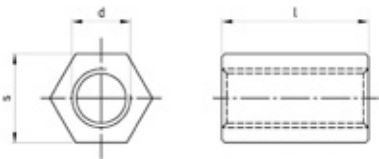

Technical data							
d	l/mm	Item no. A2	Item no. A4	s =drive	Unit	Unit	

Other diameters/materials on request

Screw sockets - round with continuous female thread

Version: round

Material: stainless steel A2 / A4

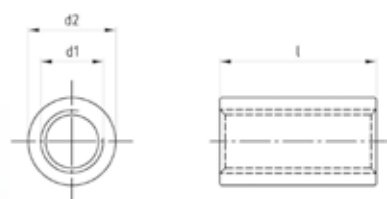

Technical data

d	l/mm	Item no. A2	Item no. A4	d2= external diameter	Unit
---	------	-------------	-------------	-----------------------	------

Other diameters/materials on request

Washers DIN 125 shape A (without bevel)

Material: stainless steel A2 / A4



Technical data

For thread	Item no. A2	Item no. A4	d1 internal diameter	d2 external diameter	h= material thickness	Unit
------------	-------------	-------------	----------------------	----------------------	-----------------------	------

Other diameters/materials on request

Washers DIN 9021

Material: stainless steel A2 / A4

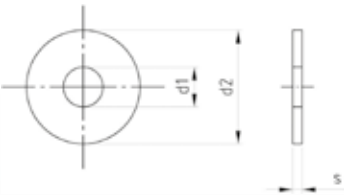

Technical data						
For thread	Item no. A2	Item no. A4	d1 internal diameter	d2 external diameter	s= material thickness	Unit

Other diameters/materials on request

Sealing washers with EPDM coating

Material: stainless steel A2 + EPDM

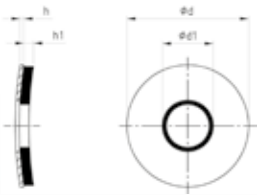

Technical data			
Diameter d1	Item no.	Diameter d external	Unit

Other diameters/materials on request

Square washers

with variable external diameters

Material: stainless steel A2 / A4

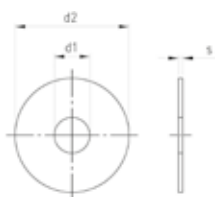

Technical data

For thread	Item no. A2	Item no. A4	d1 internal diameter	d2 external diameter	s= material thickness	Unit
------------	-------------	-------------	----------------------	----------------------	-----------------------	------

Other diameters/materials on request



General terms of supply and payment for Schäfer + Peters GmbH (hereinafter also named "S+P"), Öhringen

Version dated September 2011

1. Scope of application

1. The following sales terms and conditions apply to all the contracts concluded between the purchaser and S + P for the supply of goods, insofar as the purchaser is a company, a legal entity under public law or a special fund under public law. Orders will be fulfilled on the basis of the following terms and conditions only. The offer, offer acceptance, order confirmation and the sale of any products are subject to the present conditions. We do not recognise any contrary or different purchaser's terms unless we have expressly accepted their validity. The following sales terms and conditions also apply if we carry out the order without reservation in the awareness of the purchaser's contrary or different terms.
2. All the agreements between the purchaser and S + P regarding performance of the purchase contracts up to the point when the contract in question was concluded have been recorded in writing in the contracts. This does not affect the effectiveness of any subsequent individual agreements concluded separately.
3. Where S + P and the purchaser have concluded a framework agreement, these General Terms and Conditions shall apply to this framework agreement and to the individual supply or purchase contract.
4. The General Terms and Conditions shall also apply to all future business dealings even if they are not expressly agreed again.

II. Offer and conclusion of contract

1. Our prices can choose to accept a purchaser's order, which qualifies as a legally binding offer to conclude a purchase contract, within two weeks, by either sending confirmation of the order or by providing the services or goods ordered without reservation. Our offers are subject to change without notice and are non-binding, unless we have explicitly designated them as binding. Statements about our goods (including, but not limited to technical data, dimensions, performance and consumption data and descriptions in the product information sheets or advertising material, etc.) are only approximate; they are not a guarantee of specifications, unless the guarantee has been given expressly and in writing.
3. We retain title, copyright and other proprietary rights to all illustrations, calculations, drawings and other documents. The purchaser may only pass these on to third parties with our written permission, irrespective of whether we have designated them as confidential.

III. Payment conditions

1. Our prices are ex works Öhringen, and do not include packaging, duty, insurance or any other fees applicable in individual cases, unless specified otherwise. Statutory VAT is not included in our prices. We will state the statutory amount separately on the invoice on the day the invoice is issued.
 2. Unless otherwise agreed, payment of the full invoice amount is due within 30 days of the date of the invoice and delivery. Payments made within 10 days of the invoice date are granted a 2% discount, unless the purchaser is in default of other payments to us. A payment shall not be considered complete until the amount is available to us. Payments by cheque shall not be considered complete until the cheque has been honoured.
 3. If the purchaser does not pay within the specified period, he or she will be in default without a further demand for payment having been issued. Should the purchaser be in default of payment, the statutory late payment interest rate for companies shall be applied to the purchase price. Rights shall be reserved to make further claims. If the purchaser fails to make payment following another demand, we shall be entitled to accelerate immediately all the purchaser's debts, including, but not limited to, deferred payments or payments to be made in instalments, and to refuse to supply any more goods.
 4. The purchaser shall only be authorised to offset payments and/or retain the goods if the counterclaims are derived from the same contractual relationship. If the delivery is based on an outline agreement or other long-term contractual relationship, the ability to offset payments applies only to debts from the actual legal relationship from which the principal claim and counterclaim result. If the counterclaim is not based on the same contractual relationship, the purchaser can only offset the payment if the counterclaims have been legally established, are acknowledged by us or are uncontested.
 5. If S + P has permitted the purchaser to pay by instalments, the total amount remaining will become due if the buyer delays payment of an instalment by more than 8 days.
 6. Price changes shall be permissible if more than 4 months pass between conclusion of the contract and the agreed delivery date and the price change is due to a current increase in costs for which we are not responsible. Costs are deemed to have increased if wages, material costs or sales costs have risen before the delivery. The same applies if
- General terms of supply and payment
- duty is increased or a duty is introduced or our suppliers increase their prices or there are exchange rate fluctuations. In these instances, S + P is entitled to increase the price commensurately with the rise in costs.

IV. Delivery and performance time, liability if delivery delayed.

1. Delivery times or periods which have not been expressly agreed as binding are non-binding statements only. They are only approximate and describe the expected time and date of delivery. Any different agreements regarding a binding delivery date and time must be made expressly and in writing. The delivery time will start when the purchaser has properly completed the actions incumbent on them to help bring about the delivery.
2. If we do not receive deliveries or services from our suppliers or subcontractors through no fault of our own despite having made the appropriate provisions, or do not receive them at the appropriate time or there are instances of force majeure, we shall inform our customers in good time, in writing. In this event, we are entitled to postpone the delivery or the service for the duration of the impediment, or to withdraw, partially or completely, from unfulfilled part of the contract, provided we have fulfilled our obligation to provide information as described above and have not accepted the risks associated with procurement or manufacture. Instances of force majeure are strikes, lock-out, intervention by authorities, lack of power or raw materials, transport bottlenecks through no fault of ours, operational impediments through no fault of ours such as fire, water, damage to machinery and all other impediments which from an objective point of view are not our fault. If the delivery or the service is delayed by more than a month, then both we and the customer – to the exclusion of all claims for damages – shall be entitled to withdraw from the contract where the quantity affected by the delivery problems is concerned. The customer shall be entitled to withdraw from the entire contract if a partial delivery is unacceptable to them.
3. In any case we will not be deemed to be delaying delivery until a subsequent reasonable period set by the customer has expired, unless the transaction includes delivery by a fixed date within the meaning of Section 286 para. 2 no. 4 German Civil Code (BGB) or Section 376 German Commercial Code.
4. Claims for damages arising from delayed delivery are excluded, provided they are not the result of intentional or gross negligence on our part or that of our agents or of culpable infringement of material contractual obligations. Material obligations are those which protect the customer's material contractual legal position and which have to be granted to the customer under the contract in terms of subject matter and purpose; also material are those contractual obligations whose fulfilment makes the due performance of the contract possible in the first place and on which the contractual partner regularly relies and may rely. Exclusion of liability for ordinary negligence shall not apply to damages resulting from loss of life, physical injuries or damage to health or from the infringement of substantive contractual obligations or which affect warranties. However, where a substantive contractual obligation has been infringed as the result of ordinary negligence, we shall only be liable for average damages that are foreseeable, typical and immediate, given the type of contract concluded.
5. Should we be responsible for delaying the delivery, the purchaser may claim lump sum compensation amounting to 0.5% of the value of the delivery for every full week of the delay, up to a maximum of 5% of the value of the delivery, unless we show that he or she has suffered less or no damage.
6. We shall be entitled to make partial deliveries or deliver partial services at any time if the customer can be reasonably expected to accept this.
7. If the purchaser delays accepting the goods, we shall be entitled to request compensation for the losses this causes and for any extra expenditures. The same applies if the purchaser culpably fails to fulfil their duty to cooperate.

V. Place of performance, transfer of risk, dispatch and packing

1. Where no other agreement has been made, the place of performance shall be our registered company offices in Öhringen.
2. Where no other agreement has been made, the risk of accidental damage or loss of the goods shall pass to the purchaser as follows: as soon as the goods are not dispatched from our warehouse in Öhringen, at the time when the goods are made available to the first transport person, or, if the purchaser is delaying acceptance, at the time at which we offer the transfer in such a way as to constitute a delay, provided the goods are dispatched from our warehouse in Öhringen at the time at which we inform the customer the goods are available for collection. Loading and dispatch are not insured and are at the purchaser's risk.
3. We shall endeavour to take account of the purchaser's wishes and interests regarding the method and route of dispatch; any consequent extra costs – even when carriage paid has been agreed – will be charged to the purchaser.
4. In accordance with German packaging regulations, we do not take back any transport or other packaging, with the exception of pallets. The packaging becomes the purchaser's property and must be disposed of their expense.
5. If dispatch is delayed at the request or fault of the purchaser, we shall store the goods at the purchaser's expense and risk. In this case, notification that we are ready to dispatch shall be the equivalent of dispatch.
6. At the purchaser's request and expense we shall insure the delivery through a transport insurance company. Express, written instructions from the purchaser are required to effect this.

VI. Warranty / limits of liability / compensation for wasted expenditure

1. Warranty claims by the purchaser are only valid if the purchaser has correctly fulfilled their statutory obligations in examining the goods and making a complaint. We must be notified in writing of detectable defects within one week of receipt of the goods. If this is not done, the goods shall be deemed approved. S + P must be notified of hidden defects as soon as they are found.
 2. If there is a defect in the goods for which we are responsible, we are initially obliged, to the exclusion of the purchaser's right to cancel the contract or reduce the purchase price, to rectify the defect unless we are authorised by legal regulation to refuse subsequent performance. The purchaser must allow us a reasonable period to effect subsequent performance. The purchaser can choose to have the defect rectified through elimination (correction) or through delivery of new goods. Where the defect is eliminated, we shall bear the necessary expenses, provided these do not increase because the object of the contract is at a location other than the place of performance.
- If the rectification to which the purchaser is entitled fails or it is unreasonable to expect the purchaser to accept it, or the rectification is refused under the provisions of Section 439 para. 3 German Civil Code, or, the interests of both parties having been weighed up, the circumstances are such that require immediate claim for compensation for damages or withdrawal, the purchaser can request that the purchase price be reduced or announce withdrawal from the contract.

The purchaser can only assert claims for compensation for damages due to the defect under the following conditions if the rectification has failed. The right of the purchaser to assert further claims for damages under the following conditions shall not be affected.

3. Claims in accordance with Section 478 German Civil Code (Recourse of the entrepreneur) asserted by the purchaser against S + P shall exist only in so far as the purchaser has not entered into any agreements with his or her customer which contain provisions which extend beyond statutory warranty claims (see point 4). The claim is excluded if the purchaser has not correctly fulfilled their statutory obligations to examine the goods and make a complaint.
4. The obligation stated in para.VI, item 3 is excluded if the defect is based on advertising statements or other contractual agreements which did not originate with us or if the purchaser has given the end user a special warranty. The obligation is similarly excluded if the purchaser was under no obligation towards the end user under the statutory regulations governing the exercise of warranty rights or had not made this objection to a claim filed against them. This also applies if the purchaser has given the end user warranties which extend beyond the statutory requirements.
5. Claims for damages arising from defects in the title or quality shall be excluded provided they are not the result of intentional or gross negligence on our part or that of our agents or a culpable infringement of substantive contractual obligations. Material obligations are those which protect the customer's material contractual legal position and which have to be granted to the customer under the contract in terms of subject matter and purpose; also material are those contractual obligations whose fulfilment makes the due performance of the contract possible in the first place and on which the contractual partner regularly relies and may rely.
- Exclusion of liability for ordinary negligence shall not apply to damages resulting from loss of life, physical injuries or damage to health or from the infringement of substantive contractual obligations or which affect warranties. However, where a substantive contractual obligation has been infringed as the result of ordinary negligence, we shall only be liable for average damages that are foreseeable, typical and immediate, given the type of contract concluded.
7. Claims for compensation for wasted expenditure arising from Section 284 BGB (German Civil Code) shall be waived if, in accordance with the above, a claim for compensation for damage in the place of effective performance has been excluded in the contract.

VII. Liability

Claims for damages resulting from infringement of a non-contractual obligation (tortious liability) or from culpability on or previous to concluding the contract (culpa in contrahendo) and for other legal reasons, including, but not limited to infringement of the general obligation to be considerate (section 241 para. 2 German Civil Code) or other contractual obligations (Section 280 Section 1 German Civil Code) provided these are not already claims against warranty shall be excluded, provided they are not the result of intentional or gross negligence on our part or that of our agents or of the culpable infringement of substantive contractual obligations. This includes but is not limited to, our liability where a substantive contractual obligation has been infringed as the result of ordinary negligence, for average damages that given the type of contract concluded are foreseeable, typical and immediate.

Exclusion of liability for ordinary negligence shall not apply to damages resulting from loss of life, physical injuries or damage to health or from the infringement of substantive contractual obligations or which affect warranties.

VIII. Statute of limitations

Claims of the purchaser for warranty and compensation for damages (items IV, VI, VII) shall fall under the statute of limitations one year after the goods have been delivered. This shall not apply where we are liable for damages which result from loss of life, physical injuries or damage to health and the culpable infringement are based on fraudulently concealed defects, or affect warranties and claims under product liability legislation. The shortening of the period of the statute of limitations shall not apply in the event of recourse of the entrepreneur (Sections 478 and 479 of the German Civil Code) or the object purchased is a building or has been as a building in accordance with customary use and caused its defectiveness (Section 438 para. 1 no. 2 German Civil Code).

IX. Reservation of title

1. The goods supplied by us remain our property until all existing or future claims upon the purchaser, that are due to us for any legal reason arising from the on-going business relationship and/or the actual purchase contract, are satisfied. If the purchaser is in breach of the contract, such as payment default, we are entitled, after prior setting of an appropriate period, to take back the goods subject to reservation of title. If we take back the goods subject to reservation of title, this shall represent a withdrawal from the contract. If we seize the goods subject to reservation of title, this shall constitute withdrawal from the contract. We shall be entitled to resell the goods subject to reservation of title after taking them back. After subtracting an appropriate amount for the costs of reselling, the proceeds of the resale will be used to offset the monies owed to us by the purchaser.
 2. The purchaser must handle the goods subject to reservation of title carefully and insure them against fire, water and theft damage at their own expense for their replacement value. The purchaser must carry out any required maintenance and service work at their expense. The purchaser shall also be obliged, at S + P's request, to inform us at any time about the condition of the goods and to tell us where they are stored.
 3. The purchaser shall be entitled to sell and/or use the goods subject to reservation of title in a proper business transaction as long as he or she is not in default of payment. Pledging or assignment as collateral is not permitted. The purchaser shall assign to us all receivables arising from a sale or other legal basis (insurance, non-permitted activity) of the goods subject to reservation of title (including all current account balance claims) now for reasons of safety; we hereby accept the assignment. We authorise the purchaser until revocation to collect the assigned accounts receivable for the purchaser's account in their own name. The authorisation to collect the accounts receivable can be revoked at any time if the purchaser does not fulfil their payment obligations correctly. The purchaser is not authorised to assign these receivables for the purposes of collecting the receivables through factoring, unless the factor's obligation is simultaneously established to effect the counter-performance directly to us for as long as we have claims against the purchaser. Furthermore, the purchaser is obliged to inform us immediately of any seizure of the goods or other impairment by third parties.
 4. Processing or conversion of the goods subject to reservation of title is, in every case, undertaken by the purchaser on our behalf. If the goods subject to reservation of title are processed with objects that do not belong to us, we shall acquire joint ownership of the new object to the value of the goods subject to retention (final invoice amount, including VAT) relative to the other processed objects at the time of processing. If the goods subject to reservation of title are inseparably combined with objects that do not belong to us, we shall acquire joint ownership of the new object in the ratio of the value of the goods subject to reservation of title (final invoice amount, including VAT) to the value of the other combined objects at the time of combination. If the purchaser's object is to be deemed a primary object as a result of the combination, we and the purchaser agree that the purchaser transfers proportional joint ownership in this object to us; we hereby accept the transfer. The purchaser shall store our exclusive or joint property created in this way. The same applies to the new object created from the processing or conversion as for the goods subject to reservation of title, but with the restriction that the purchaser assigns claims from third parties to us in the amount of joint ownership we acquired as stated above.
 5. If third parties access the goods subject to retention, including but not limited to seizures, the purchaser shall make them aware of our title and inform us immediately so that we can assert our right to title. If the third party is unable to reimburse us for any legal or non-legal costs arising in this connection, the purchaser shall be liable for them.
 6. We shall be obliged to release the collateral owed to us in so far as the realisable value of our collateral exceeds the claims to be secured by more than 10%; we are entitled to choose which collateral to release.
- ## X. Place of performance, choice of forum, applicable legislation
1. The place of performance and place of jurisdiction for deliveries and payments (including cheque or bill actions) and for all disputes between us and the purchaser arising from the purchase contracts concluded between us and them shall be Öhringen. However, we are entitled to file a complaint against the purchaser at their place of residence or business.
 2. The legal relationship between us and our customers or between us and third parties shall be governed exclusively by the laws of the Federal Republic of Germany.

XI. Miscellaneous

1. In the event that one or more of the provisions in this agreement is or becomes partly invalid or incomplete, or is excluded by a special agreement, this shall not affect the validity of the remaining provisions.
2. We wish to point out that we store our customers' data as part of our mutual business relationships in accordance with the German Federal Data Protection Act.

Schäfer + Peters GmbH



Schäfer + Peters GmbH
Zeilbaumweg 32
DE-74613 Öhringen
Tel. +49 (0) 7941 6094-0
Fax +49 (0) 7941 6094-700
info@schaefer-peters.com
www.schaefer-peters.com