

## ■ POP<sup>®</sup> Soft-Set blind rivets

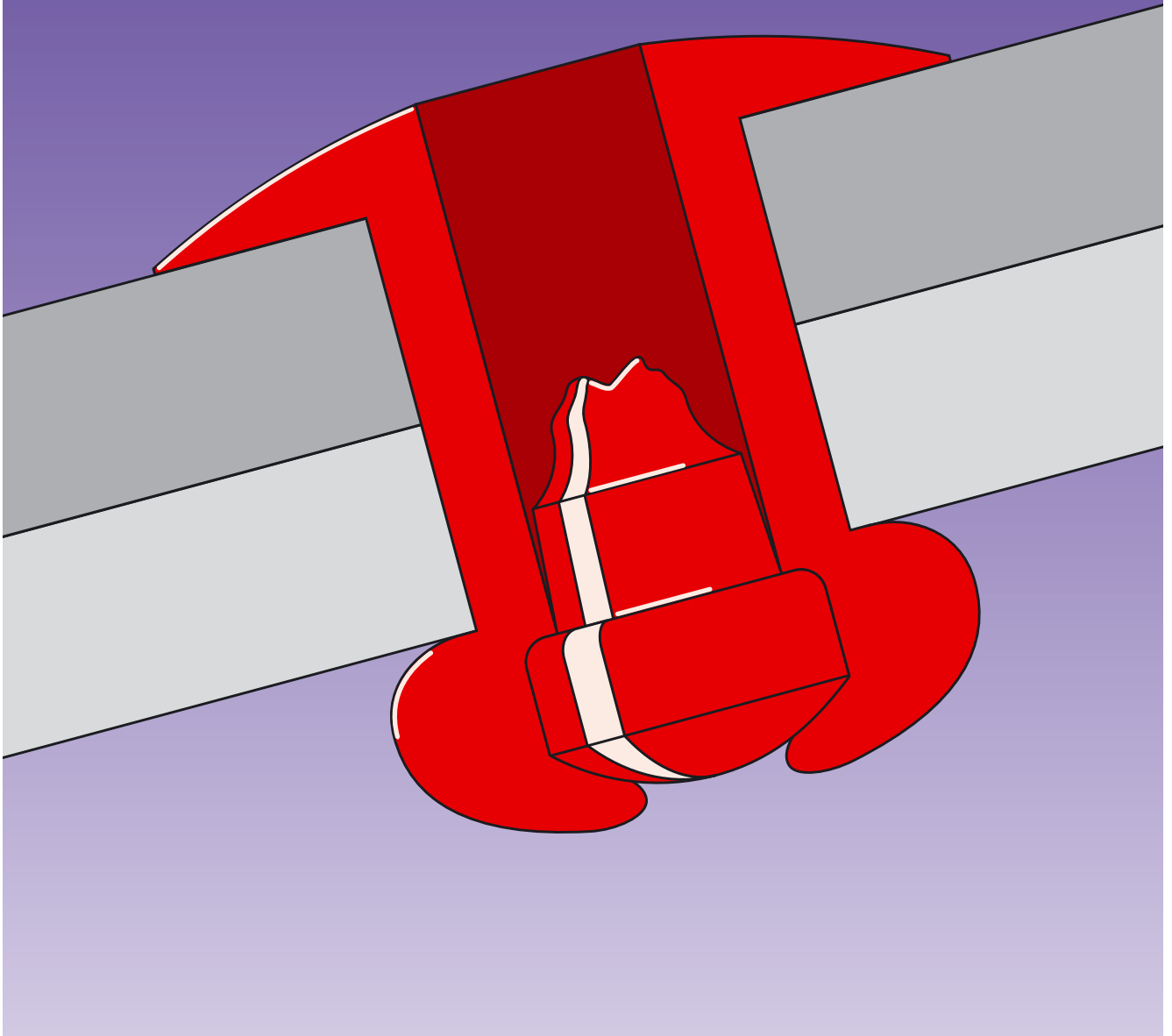

# POP® Soft-Set blind rivets

Dome head

## Material

- **Sleeve**  
Aluminium Al99  
Melting point 650 – 660 °C
- **Mandrel**  
Aluminium AlZnMgCu 1.5

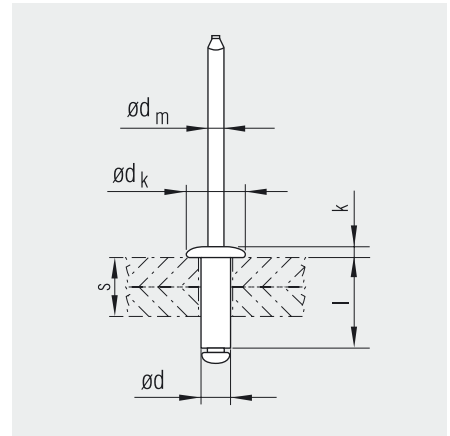

Nominal size- $\varnothing$ d [mm]	Hole- $\varnothing$ [mm]	Grip range s [mm]	Sleeve length $l$ +1.0 -0.2 [mm]	Head		Mandrel $\varnothing$ $d_{m\ nom}$ [mm]	Strength <sup>1</sup> nominal		Part No.
				$\varnothing$ $d_k \pm 0.3$ [mm]	Height $k \pm 0.2$ [mm]		Shear [N]	Tensile [N]	
3.2	3.3	4.8 – 6.4	9.5	6.5	1.0	1.9	280	370	300 910
		6.4 – 9.5	12.7	6.5	1.0	1.9	280	370	300 911
		9.5 – 12.7	15.9	6.5	1.0	1.9	280	370	300 912
4.0	4.1	3.2 – 6.4	10.2	8.0	1.2	2.4	460	640	300 920
		6.4 – 9.5	13.0	8.0	1.2	2.4	460	640	300 921
		9.5 – 12.7	16.4	8.0	1.2	2.4	460	640	300 922
4.8	4.9	6.4 – 9.5	14.0	9.5	1.4	2.9	650	910	300 930
		9.5 – 12.7	16.8	9.5	1.4	2.9	650	910	300 931

<sup>1</sup> Minimum based on rivet failure

We reserve the right to amend specifications at any time.