

■ POP[®] Standard blind rivets

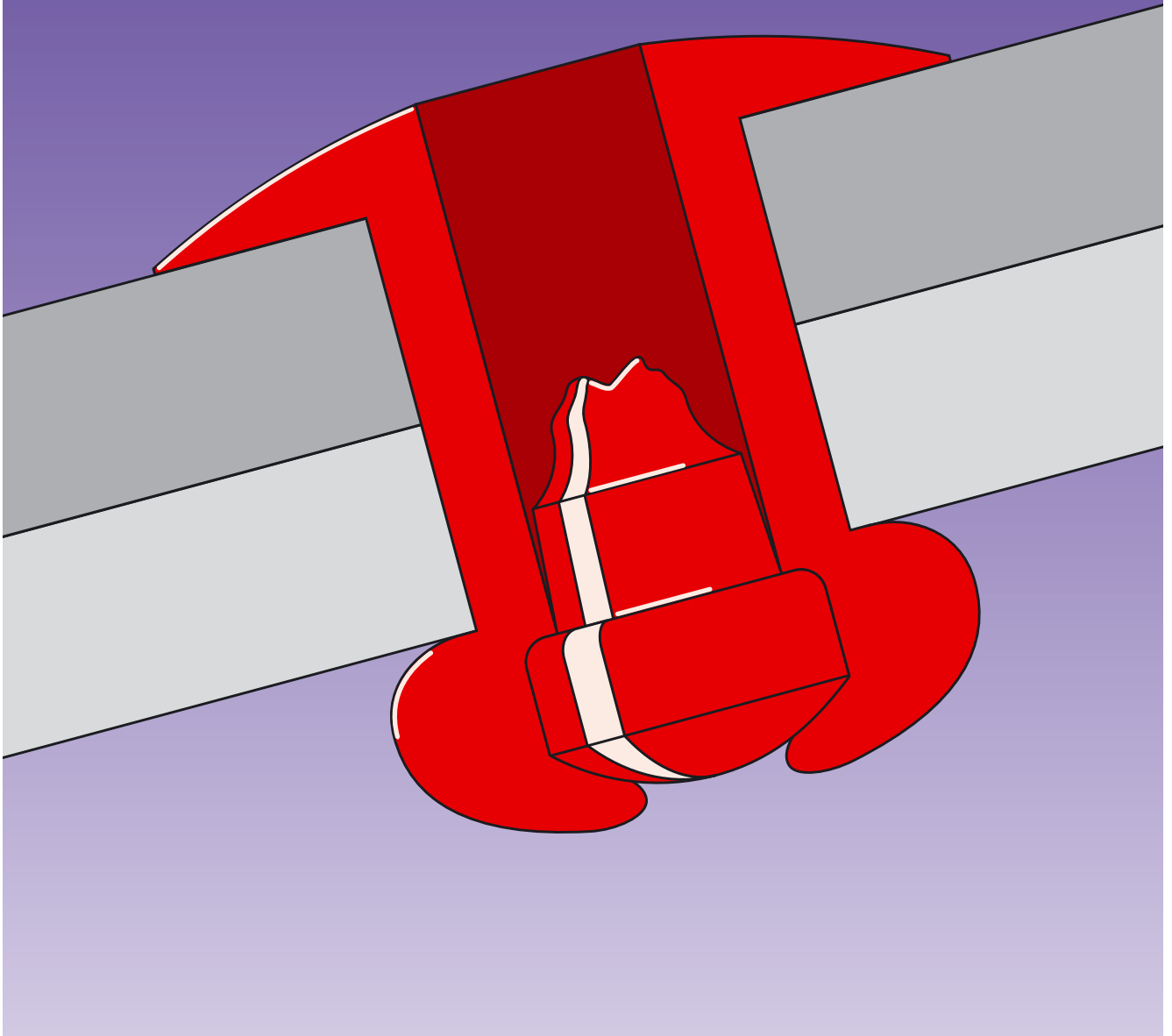

POP® Standard blind rivets

Dome head

Material

Sleeve
Aluminium AlMg 3/3.5
Melting point 590 – 610 °C

Mandrel
Steel zinc

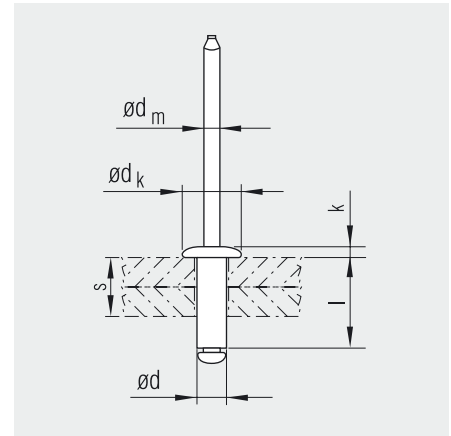

Nominal size- \varnothing d [mm]	Hole- \varnothing [mm]	Grip range s [mm]	Sleeve length l +1.0 -0.2 [mm]	Head		Mandrel \varnothing dm nom [mm]	Strength ¹ nominal		Part No.
				\varnothing dk ±0.3 [mm]	Height k ±0.2 [mm]		Shear [N]	Tensile [N]	
2.4	2.5	0.5 – 0.8	3.5	4.7	0.8	1.4	400	500	304 170
		0.8 – 2.4	5.0	4.7	0.8	1.4	400	500	304 171
		2.4 – 4.8	7.5	4.7	0.8	1.4	400	500	304 172
3.0	3.1	0.5 – 2.0	5.0	6.0	1.0	1.8	800	1000	301 370
		2.0 – 3.5	6.5	6.0	1.0	1.8	800	1000	301 371
		3.5 – 5.0	8.0	6.0	1.0	1.8	800	1000	301 372
		5.0 – 7.0	10.0	6.0	1.0	1.8	800	1000	301 373
		7.0 – 9.0	12.0	6.0	1.0	1.8	800	1000	301 374
		9.0 – 12.0	15.0	6.0	1.0	1.8	800	1000	301 375
3.2	3.3	- 1.6	4.5	6.4	1.0	1.8	800	1200	304 370
		1.6 – 3.2	6.0	6.4	1.0	1.8	800	1200	304 371
		3.2 – 4.8	8.0	6.4	1.0	1.8	800	1200	304 372
		4.8 – 6.4	9.7	6.4	1.0	1.8	800	1200	304 373
		6.4 – 7.9	11.5	6.4	1.0	1.8	800	1200	304 374
		7.9 – 9.5	13.5	6.4	1.0	1.8	800	1200	304 375
		9.5 – 11.1	15.0	6.4	1.0	1.8	800	1200	304 378
		11.1 – 12.7	17.0	6.4	1.0	1.8	800	1200	304 376
		12.7 – 14.3	18.5	6.4	1.0	1.8	800	1200	304 377
		14.3 – 16.6	20.0	6.4	1.0	1.8	800	1200	304 338
4.0	4.1	16.6 – 20.7	24.0	6.4	1.0	1.8	800	1200	304 339
		- 1.6	4.9	7.9	1.3	2.3	1330	1910	304 470
		- 3.2	7.0	7.9	1.3	2.3	1330	1910	304 471
		3.2 – 4.8	8.5	7.9	1.3	2.3	1330	1910	304 472
		4.8 – 6.4	10.5	7.9	1.3	2.3	1330	1910	304 473
		6.4 – 7.9	12.2	7.9	1.3	2.3	1330	1910	304 474
		7.9 – 9.5	14.0	7.9	1.3	2.3	1330	1910	304 475
		9.5 – 11.1	15.7	7.9	1.3	2.3	1330	1910	304 476
		11.1 – 12.7	17.5	7.9	1.3	2.3	1330	1910	304 477
		12.7 – 13.5	18.5	7.9	1.3	2.3	1330	1910	304 478
		13.5 – 15.9	20.2	7.9	1.3	2.3	1330	1910	304 479
		15.9 – 17.4	22.5	7.9	1.3	2.3	1330	1910	304 490
17.4 – 19.8	24.7	7.9	1.3	2.3	1330	1910	304 491		

We reserve the right to amend specifications at any time.

Continue next page

Continued

Nominal size- \varnothing d [mm]	Hole- \varnothing [mm]	Grip range s [mm]	Sleeve length $l_{+1.0 -0.2}$ [mm]	Head		Mandrel \varnothing $d_{m\ nom}$ [mm]	Strength ¹ nominal		Part No.
				\varnothing $d_k \pm 0.3$ [mm]	Height $k \pm 0.2$ [mm]		Shear [N]	Tensile [N]	
4.8	4.9	-2.3	6.5	9.5	1.6	2.6	2020	2800	304 530
		-3.2	7.5	9.5	1.6	2.6	2020	2800	304 531
		3.2-4.8	9.2	9.5	1.6	2.6	2020	2800	304 532
		4.8-6.4	11.0	9.5	1.6	2.6	2020	2800	304 533
		6.4-7.9	12.7	9.5	1.6	2.6	2020	2800	304 534
		7.9-9.5	14.7	9.5	1.6	2.6	2020	2800	304 535
		9.5-11.1	16.5	9.5	1.6	2.6	2020	2800	304 536
		11.1-12.7	18.0	9.5	1.6	2.6	2020	2800	304 537
		11.1-13.5	19.0	9.5	1.6	2.6	2020	2800	304 538
		13.5-16.0	21.0	9.5	1.6	2.6	2020	2800	304 564
		16.0-19.8	25.5	9.5	1.6	2.6	2020	2800	304 566
		19.1-22.2	27.1	9.5	1.6	2.6	2020	2800	304 539²
		19.8-26.2	32.0	9.5	1.6	2.6	2020	2800	304 567
		20.0-34.0	40.0	9.5	1.6	2.6	2020	2800	304 554
		25.0-39.0	45.0	9.5	1.6	2.6	2020	2800	304 557
		30.0-44.0	50.0	9.5	1.6	2.6	2020	2800	304 558
		41.0-46.0	55.0	9.5	1.6	2.6	2020	2800	304 559
46.0-52.0	60.0	9.5	1.6	2.6	2020	2800	304 560		
52.0-60.0	70.0	9.5	1.6	2.6	2020	2800	304 561		
60.0-70.0	80.0	9.5	1.6	2.6	2020	2800	304 562		
5.0	5.1	0.5-3.5	6.5	9.0	1.6	2.6	2200	2600	301 531
		3.5-4.5	8.0	9.0	1.6	2.6	2200	2600	301 532
		4.5-6.0	10.0	9.0	1.6	2.6	2200	2600	301 533
		6.0-7.5	12.0	9.0	1.6	2.6	2200	2600	301 534
		7.5-9.5	14.0	9.0	1.6	2.6	2200	2600	301 535
		9.5-11.5	16.0	9.0	1.6	2.6	2200	2600	301 536
		11.5-13.5	18.0	9.0	1.6	2.6	2200	2600	301 537
		13.5-15.5	20.0	9.0	1.6	2.6	2200	2600	301 538
		15.5-17.5	22.0	9.0	1.6	2.6	2200	2600	301 539
17.5-20.5	25.0	9.0	1.6	2.6	2200	2600	301 560		
6.4	6.5	3.0-6.4	12.7	12.7	2.1	3.7	3200	4525	304 629
		6.4-12.7	19.5	12.7	2.1	3.7	3200	4525	304 630
		12.7-19.0	26.2	12.7	2.1	3.7	3200	4525	304 631
		19.1-25.4	31.5	12.7	2.1	3.7	3200	4525	304 632²

¹ Minimum based on rivet failure² Rivet sleeve AlMg 5; melting point 580 – 640°C, mandrel steel, phosphated

We reserve the right to amend specifications at any time.

POP® Standard blind rivets

Large dome head

Material

Sleeve
Aluminium AlMg 3/3.5
Melting point 590 – 610 °C

Mandrel
Steel zinc

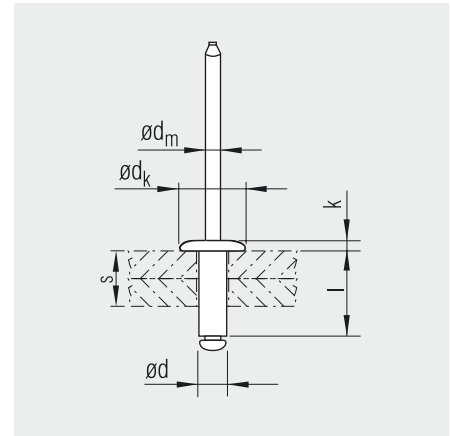

Nominal size- \varnothing d [mm]	Hole- \varnothing [mm]	Grip range s [mm]	Sleeve length l $+1.0$ -0.2 [mm]	Head		Mandrel \varnothing $d_{m\ nom}$ [mm]	Strength ¹ nominal		Part No.
				\varnothing $d_k \pm 0.3$ [mm]	Height $k \pm 0.2$ [mm]		Shear [N]	Tensile [N]	
3.2	3.3	0.5 – 3.2	6.2	9.5	1.5	1.8	800	1200	306 371
		3.2 – 4.8	8.0	9.5	1.5	1.8	800	1200	306 372
		4.8 – 6.4	9.7	9.5	1.5	1.8	800	1200	306 373
		6.4 – 7.9	11.5	9.5	1.5	1.8	800	1200	306 374
		7.9 – 9.5	13.5	9.5	1.5	1.8	800	1200	306 375
		9.5 – 12.7	17.0	9.5	1.5	1.8	800	1200	306 377
4.0	4.1	1.5 – 4.8	8.5	12.0	1.6	2.3	1330	1910	306 472
		4.8 – 6.4	10.5	12.0	1.6	2.3	1330	1910	306 473
		6.4 – 7.9	12.2	12.0	1.6	2.3	1330	1910	306 474
		7.9 – 9.5	14.0	12.0	1.6	2.3	1330	1910	306 475
		9.5 – 11.1	15.5	12.0	1.6	2.3	1330	1910	306 476
		11.1 – 12.7	17.5	12.0	1.6	2.3	1330	1910	306 477
		12.7 – 14.3	19.4	12.0	1.6	2.3	1330	1910	306 478
4.8	4.9	3.2 – 4.8	9.2	11.0	1.8	2.6	2020	2800	306 532
		4.8 – 6.4	11.0	11.0	1.8	2.6	2020	2800	306 533
		6.4 – 7.9	12.7	11.0	1.8	2.6	2020	2800	306 534
		7.9 – 9.5	14.5	11.0	1.8	2.6	2020	2800	306 535
		9.5 – 11.1	16.5	11.0	1.8	2.6	2020	2800	306 536
		11.1 – 12.7	18.2	11.0	1.8	2.6	2020	2800	306 537
		12.7 – 13.5	19.0	11.0	1.8	2.6	2020	2800	306 538
		19.0 – 21.0	25.0	11.0	1.8	2.6	2020	2800	306 551
		23.0 – 25.0	30.0	11.0	1.8	2.6	2020	2800	306 552
		25.0 – 30.0	35.0	11.0	1.8	2.6	2020	2800	306 553
		30.0 – 35.0	40.0	11.0	1.8	2.6	2020	2800	306 554
		35.0 – 40.0	45.0	11.0	1.8	2.6	2020	2800	306 557
40.0 – 45.0	50.0	11.0	1.8	2.6	2020	2800	306 558		

We reserve the right to amend specifications at any time.

Continue next page

Continued

Nominal size- \varnothing d [mm]	Hole- \varnothing [mm]	Grip range s [mm]	Sleeve length $l \pm 1.0 \ -0.2$ [mm]	Head		Mandrel \varnothing d_m^{nom} [mm]	Strength ¹ nominal		Part No.
				$d_k \pm 0.3$ [mm]	Height $k \pm 0.2$ [mm]		Shear [N]	Tensile [N]	
4.8	4.9	1.5 – 4.8	9.2	14.0	2.0	2.6	2020	2800	306 192
		4.8 – 6.4	11.0	14.0	2.0	2.6	2020	2800	306 193
		6.4 – 7.9	12.7	14.0	2.0	2.6	2020	2800	306 194
		7.9 – 9.5	14.5	14.0	2.0	2.6	2020	2800	306 195
		9.5 – 11.1	16.5	14.0	2.0	2.6	2020	2800	306 196
		11.1 – 12.7	18.2	14.0	2.0	2.6	2020	2800	306 197
		12.7 – 13.5	19.0	14.0	2.0	2.6	2020	2800	306 198
		14.3 – 19.1	23.9	15.9	2.1	2.9	2020	3270	306 099²
		19.1 – 25.4	30.3	15.9	2.1	2.9	2020	3270	306 101²

¹ Minimum based on rivet failure

² Rivet sleeve AlMg 5; melting point 580 – 640°C, mandrel steel, phosphated

We reserve the right to amend specifications at any time.

Blind rivets

POP® Standard blind rivets

Countersunk head 120°

Material

Sleeve
Aluminium AlMg 3/3.5
Melting point 590 – 610 °C

Mandrel
Steel zinc

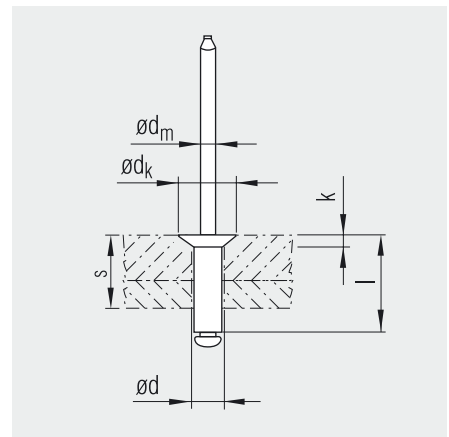

Nominal size- \varnothing d [mm]	Hole- \varnothing [mm]	Grip range s [mm]	Sleeve length $l +1.0 -0.2$ [mm]	Head		Mandrel \varnothing $d_{m\ nom}$ [mm]	Strength ¹ nominal		Part No.
				\varnothing $d_k \pm 0.3$ [mm]	Height $k \pm 0.2$ [mm]		Shear [N]	Tensile [N]	
2.4	2.5	1.6 – 3.2	6.0	4.7	1.0	1.4	400	500	304 180
		3.2 – 5.6	8.5	4.7	1.0				304 181
3.2	3.3	0.5 – 2.7	5.5	6.4	1.1	1.8	800	1200	304 380
		2.7 – 4.3	7.5	6.4	1.1				304 381
		4.3 – 5.8	9.0	6.4	1.1				304 382
		5.8 – 7.4	11.0	6.4	1.1				304 383
		7.4 – 9.0	12.7	6.4	1.1				304 384
		9.0 – 10.6	14.5	6.4	1.1				304 385
		10.6 – 12.2	16.2	6.4	1.1				304 387
		12.2 – 13.8	18.0	6.4	1.1				304 386
		13.8 – 15.4	19.7	6.4	1.1				304 388
4.0	4.1	– 4.5	8.5	7.9	1.5	2.3	1330	1910	304 481
		4.5 – 6.1	10.0	7.9	1.5				304 482
		6.1 – 7.7	12.0	7.9	1.5				304 483
		7.7 – 9.3	13.5	7.9	1.5				304 484
		9.3 – 10.9	15.5	7.9	1.5				304 485
		10.9 – 12.4	17.0	7.9	1.5				304 486
		12.4 – 14.0	19.0	7.9	1.5				304 487
4.8	4.9	– 1.6	8.5	9.5	2.0	2.6	2020	2800	304 540
		– 4.8	9.5	9.5	2.0				304 541
		4.8 – 6.4	11.0	9.5	2.0				304 542
		6.4 – 8.0	13.0	9.5	2.0				304 543
		8.0 – 9.5	14.5	9.5	2.0				304 544
		9.5 – 11.1	16.5	9.5	2.0				304 545
		11.1 – 12.7	18.2	9.5	2.0				304 546
		12.7 – 15.1	21.0	9.5	2.0				304 548
		15.1 – 21.4	27.5	9.5	2.0				304 549
21.4 – 27.8	34.0	9.5	2.0	304 589					

¹ Minimum based on rivet failure

Head break type on request.

We reserve the right to amend specifications at any time.

POP® Standard blind rivets

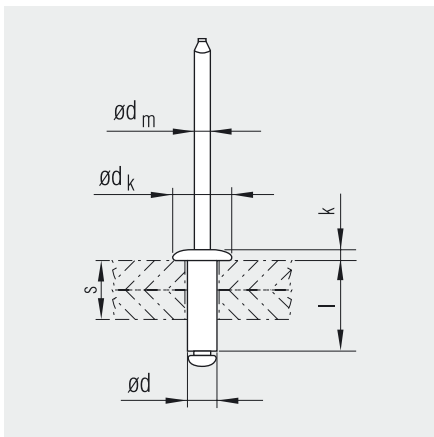

Dome head

Material

- **Sleeve**
Aluminium AlMg 3/3.5
Melting point 590 – 610 °C
- **Mandrel**
Stainless steel 1.4541

Blind rivets

Nominal size-Ø d [mm]	Hole-Ø [mm]	Grip range s [mm]	Sleeve length $l +1.0 -0.2$ [mm]	Head		Mandrel Ø $d_{m\ nom}$ [mm]	Strength ¹ nominal		Part No.
				Ø $d_k \pm 0.3$ [mm]	Height $k \pm 0.2$ [mm]		Shear [N]	Tensile [N]	
3.2	3.3	1.6 – 3.2	6.0	6.4	1.0	1.8	800	1200	307 371
		3.2 – 4.8	8.0	6.4	1.0	1.8	800	1200	307 372
		4.8 – 6.4	9.7	6.4	1.0	1.8	800	1200	307 373
		6.4 – 7.9	11.5	6.4	1.0	1.8	800	1200	307 374
4.0	4.1	– 3.2	7.0	7.9	1.3	2.3	1330	1910	307 471
		3.2 – 4.8	8.5	7.9	1.3	2.3	1330	1910	307 472
		4.8 – 6.4	10.5	7.9	1.3	2.3	1330	1910	307 473
		6.4 – 7.9	12.0	7.9	1.3	2.3	1330	1200	307 474
		7.9 – 9.5	14.0	7.9	1.3	2.3	1330	1910	307 475
		9.5 – 11.1	15.7	7.9	1.3	2.3	1330	1910	307 476
		11.1 – 12.7	17.5	7.9	1.3	2.3	1330	1910	307 477
4.8	4.9	0.5 – 3.2	7.5	9.5	1.6	2.6	2020	2800	307 531
		3.2 – 4.8	9.0	9.5	1.6	2.6	2020	2800	307 532
		4.8 – 6.4	11.0	9.5	1.6	2.6	2020	2800	307 533
		6.4 – 7.9	12.7	9.5	1.6	2.6	2020	2800	307 534
		7.9 – 9.5	14.7	9.5	1.6	2.6	2020	2800	307 535
		9.5 – 11.1	16.5	9.5	1.6	2.6	2020	2800	307 536
		11.1 – 13.5	19.0	9.5	1.6	2.6	2020	2800	307 538

¹ Minimum based on rivet failure

We reserve the right to amend specifications at any time.

POP® Standard blind rivets

Large dome head

Material

Sleeve
Aluminium AlMg 3/3.5
 Melting point 590 – 610 °C

Mandrel
Stainless steel 1.4541

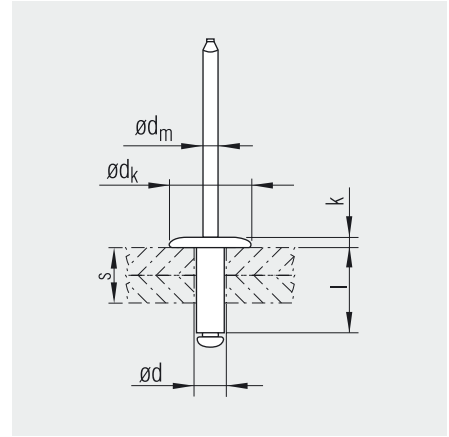

Nominal size- \varnothing d [mm]	Hole- \varnothing [mm]	Grip range s [mm]	Sleeve length l +1.0 -0.2 [mm]	Head		Mandrel \varnothing $d_{m\ nom}$ [mm]	Strength ¹ nominal		Part No.
				\varnothing $d_k \pm 0.3$ [mm]	Height $k \pm 0.2$ [mm]		Shear [N]	Tensile [N]	
4.8	4.9	1.5 – 4.8	9.2	11.0	2.0	2.6	2020	2800	307 232
		4.8 – 6.4	11.0	14.0	2.0	2.6	2020	2800	307 193
		6.4 – 7.9	12.7	14.0	2.0	2.6	2020	2800	307 194
		7.9 – 9.5	14.5	14.0	2.0	2.6	2020	2800	307 195
		9.5 – 11.1	16.5	14.0	2.0	2.6	2020	2800	307 196
		11.2 – 12.7	18.2	14.0	2.0	2.6	2020	2800	307 197
		12.7 – 15.3	19.0	14.0	2.0	2.6	2020	2800	307 198

¹ Minimum based on rivet failure

We reserve the right to amend specifications at any time.

POP® Standard blind rivets

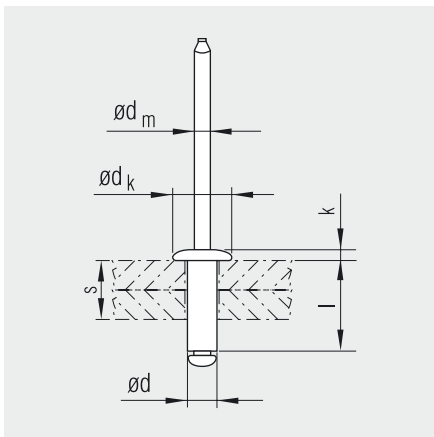

Dome head

Material

Sleeve
Aluminium AlMg 2.5
Melting point 630 °C

Mandrel
Aluminium AlMg 5

Blind rivets

Nominal size- \varnothing d [mm]	Hole- \varnothing [mm]	Grip range s [mm]	Sleeve length $l \begin{smallmatrix} +1.0 \\ -0.2 \end{smallmatrix}$ [mm]	Head		Mandrel \varnothing $d_{m \text{ nom}}$ [mm]	Strength ¹ nominal		Part No.
				\varnothing $d_k \pm 0.3$ [mm]	Height $k \pm 0.2$ [mm]		Shear [N]	Tensile [N]	
2.4	2.5	0.8 – 3.2	6.1	4.8	0.8	1.5	390	610	302 130
		3.2 – 6.4	9.3	4.8	0.8	1.5	390	610	302 131
		6.4 – 9.5	12.4	4.8	0.8	1.5	390	610	302 132
3.2	3.3	– 1.6	4.8	6.3	1.0	1.9	680	1040	302 330
		1.6 – 3.2	6.5	6.3	1.0	1.9	680	1040	302 331
		3.2 – 4.8	8.0	6.3	1.0	1.9	680	1040	302 332
		4.8 – 6.4	9.5	6.3	1.0	1.9	680	1040	302 333
		6.4 – 7.9	11.1	6.3	1.0	1.9	680	1040	302 334
		7.9 – 9.5	12.7	6.3	1.0	1.9	680	1040	302 335
		9.5 – 12.7	15.9	6.3	1.0	1.9	680	1040	302 336
		12.7 – 15.9	19.0	6.3	1.0	1.9	680	1040	302 337
4.0	4.1	0.5 – 3.2	7.0	8.0	1.2	2.4	1000	1550	302 432
		3.2 – 4.8	8.5	8.0	1.2	2.4	1000	1500	302 435
		4.8 – 6.4	10.0	8.0	1.2	2.4	1000	1550	302 433
		6.4 – 9.5	13.3	8.0	1.2	2.4	1000	1550	302 434
		9.5 – 12.7	16.5	8.0	1.2	2.4	1000	1550	302 436
4.8	4.9	0.5 – 3.2	7.6	9.5	1.4	2.9	1400	2220	302 531
		3.2 – 6.4	10.8	9.5	1.4	2.9	1400	2220	302 532
		6.4 – 9.5	14.0	9.5	1.4	2.9	1400	2220	302 533
		9.5 – 12.7	17.2	9.5	1.4	2.9	1400	2220	302 534
		12.7 – 15.9	20.3	9.5	1.4	2.9	1400	2220	302 535
		15.9 – 19.1	23.5	9.5	1.4	2.9	1400	2220	302 536
		19.1 – 25.4	29.8	9.5	1.4	2.9	1400	2220	302 537

¹ Minimum based on rivet failure

We reserve the right to amend specifications at any time.

POP® Standard blind rivets

Large dome head

Material

Sleeve
Aluminium AlMg 2.5
Melting point 630 °C

Mandrel
Aluminium AlMg 5

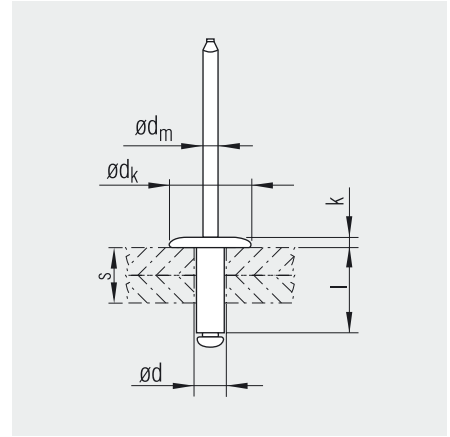

Nominal size- \varnothing d [mm]	Hole- \varnothing [mm]	Grip range s [mm]	Sleeve length l +1.0 -0.2 [mm]	Head		Mandrel \varnothing $d_{m\ nom}$ [mm]	Strength ¹ nominal		Part No.
				\varnothing $d_k \pm 0.3$ [mm]	Head $k \pm 0.2$ [mm]		Shear [N]	Tensile [N]	
3.2	3.3	0.5 – 3.2	6.5	9.5	1.1	1.9	680	1040	306 201
		3.2 – 6.4	9.5	9.5	1.1				306 202
4.0	4.1	3.2 – 6.4	10.2	12.0	0.8	2.4	1000	1550	306 213
4.8	4.9	3.2 – 6.4	10.8	16.0	2.1	2.9	1400	2220	306 221
		6.4 – 9.5	14.0	16.0	2.1				306 222
		9.5 – 12.7	17.2	16.0	2.1				306 223
		12.7 – 15.9	20.3	16.0	2.1				306 224
		15.9 – 19.1	23.5	16.0	2.1	2.9	1400	2220	306 225

¹ Minimum based on rivet failure

We reserve the right to amend specifications at any time.

POP® Standard blind rivets

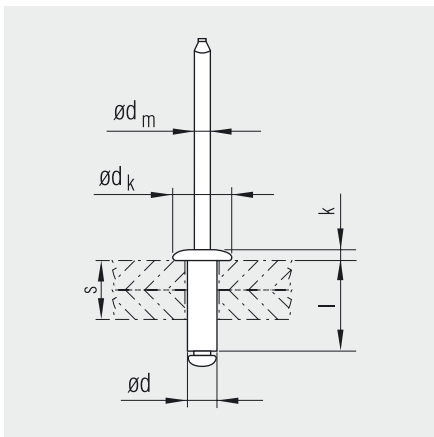

Head break
Dome head

Material

Sleeve
Aluminium AlMg 3/3.5
Melting point 590 – 610 °C

Mandrel
Steel zinc

Blind rivets

Nominal size- ϕ d [mm]	Hole- ϕ [mm]	Grip range s [mm]	Sleeve length $l \pm 1.0 -0.2$ [mm]	Head		Mandrel ϕ $d_{m \text{ nom}}$ [mm]	Strength ¹ nominal		Part No.
				ϕ $d_k \pm 0.3$ [mm]	Height k ± 0.2 [mm]		Shear [N]	Tensile [N]	
3.2	3.3	-1.6	4.4	6.5	1.0	1.8	800	1200	305 370
		1.6 – 3.2	6.2	6.5	1.0	1.8	800	1200	305 371
		3.2 – 4.8	8.0	6.5	1.0	1.8	800	1200	305 372
		4.8 – 6.4	9.8	6.5	1.0	1.8	800	1200	305 373
		6.4 – 7.9	11.6	6.5	1.0	1.8	800	1200	305 374
4.0	4.1	-1.6	5.0	8.0	1.3	2.3	1330	1910	305 470
		1.6 – 3.2	7.0	8.0	1.3	2.3	1330	1910	305 471
		3.2 – 4.8	8.5	8.0	1.3	2.3	1330	1910	305 472
		4.8 – 6.4	10.5	8.0	1.3	2.3	1330	1910	305 473
		6.4 – 7.9	12.2	8.0	1.3	2.3	1330	1910	305 474
		7.9 – 9.5	14.0	8.0	1.3	2.3	1330	1910	305 475
4.8	4.9	-3.2	6.6	8.0	1.3	2.6	2200	2800	305 530
		3.2 – 4.0	7.5	9.5	1.5	2.6	2020	2800	305 531
		4.0 – 5.6	9.2	9.5	1.5	2.6	2020	2800	305 532
		5.6 – 7.2	11.0	9.5	1.5	2.6	2020	2800	305 533
		7.2 – 8.7	12.7	9.5	1.5	2.6	2020	2800	305 534
		8.7 – 10.3	14.7	9.5	1.5	2.6	2020	2800	305 535
		10.3 – 11.9	16.5	9.5	1.5	2.6	2020	2800	305 536
11.9 – 13.5	18.2	9.5	1.5	2.6	2020	2800	305 537		

¹ Minimum based on rivet failure

The head break function depends on the properties and thickness of the materials to be joined.

Countersunk head on request.

We reserve the right to amend specifications at any time.

POP® Standard blind rivets

Dome head

Material

Sleeve
Steel zinc, passivate
Melting point 1480 – 1510 °C

Mandrel
Steel zinc

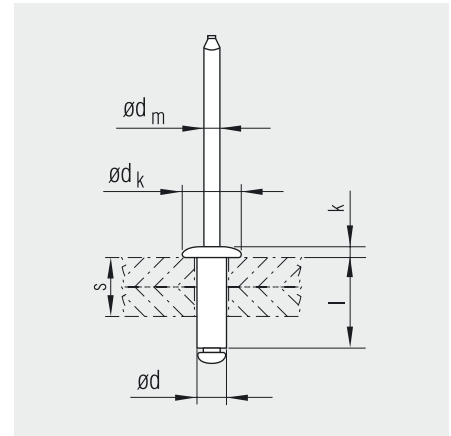

Nominal size- \varnothing d [mm]	Hole- \varnothing [mm]	Grip range s [mm]	Sleeve length $l +1.0 -0.2$ [mm]	Head		Mandrel \varnothing $d_{m\ nom}$ [mm]	Strength ¹ nominal		Part No.
				\varnothing $d_k \pm 0.3$ [mm]	Height $k \pm 0.2$ [mm]		Shear [N]	Tensile [N]	
2.4	2.5	0.5 – 2.9	5.3	4.8	0.8	1.5	700	900	304 701
3.0	3.1	– 2.0	5.0	6.0	1.0	1.8	1100	1400	301 710
		2.0 – 3.5	6.5	6.0	1.0	1.8	1100	1400	301 711
		3.5 – 5.0	8.0	6.0	1.0	1.8	1100	1400	301 712
		5.0 – 7.0	10.0	6.0	1.0	1.8	1100	1400	301 713
		7.0 – 9.0	12.0	6.0	1.0	1.8	1100	1400	301 714
3.2	3.3	9.0 – 12.0	15.0	6.0	1.0	1.8	1100	1400	301 715
		– 1.6	4.5	6.5	1.0	1.9	1150	1550	304 710
		1.6 – 3.2	6.0	6.5	1.0	1.9	1150	1550	304 711
		3.2 – 4.8	8.0	6.5	1.0	1.9	1150	1550	304 712
		4.8 – 6.4	9.5	6.5	1.0	1.9	1150	1550	306 935
		6.4 – 7.9	11.5	6.5	1.0	1.9	1150	1550	304 714
4.0	4.1	7.9 – 9.5	13.5	6.5	1.0	1.9	1150	1550	304 715
		9.5 – 11.1	15.1	6.5	1.0	1.9	1150	1550	304 716
		– 1.6	5.0	8.0	1.3	2.3	1730	2500	304 730
		1.6 – 3.2	7.0	8.0	1.3	2.3	1730	2500	304 731
		3.2 – 4.8	8.5	8.0	1.3	2.3	1730	2500	306 932
		4.8 – 6.4	10.5	8.0	1.3	2.3	1730	2500	304 733
		6.4 – 7.9	12.2	8.0	1.3	2.3	1730	2500	304 734
4.8	4.9	7.9 – 9.5	14.0	8.0	1.3	2.3	1730	2500	304 735
		9.5 – 11.1	15.9	8.0	1.3	2.3	1730	2500	304 736
		– 2.4	6.5	9.5	1.6	2.9	2620	3500	304 750
		2.4 – 3.2	7.5	9.5	1.6	2.9	2620	3500	304 751
		3.2 – 4.8	9.3	9.5	1.6	2.9	2620	3500	304 752
		4.8 – 6.4	11.0	9.5	1.6	2.9	2620	3500	304 753
		6.4 – 7.9	12.5	9.5	1.6	2.9	2620	3500	304 754
		7.9 – 9.5	14.5	9.5	1.6	2.9	2620	3500	304 755
9.5 – 11.1	16.5	9.5	1.6	2.9	2620	3500	304 756		
		12.7 – 13.5	19.0	9.5	1.6	2.9	2620	3500	304 757
		22.2 – 25.4	30.2	9.5	1.6	2.9	2620	3500	304 058 ²

We reserve the right to amend specifications at any time.

Continue next page

Continued

Nominal size- \varnothing d [mm]	Hole- \varnothing [mm]	Grip range s [mm]	Sleeve length l $+1.0 -0.2$ [mm]	Head		Mandrel \varnothing d _{m nom} [mm]	Strength ¹ nominal		Part No.
				\varnothing d _k ± 0.3 [mm]	Height k ± 0.2 [mm]		Shear [N]	Tensile [N]	
5.0	5.1	0.5 – 2.5	6.5	9.0	1.6	2.9	2880	3790	301 750
		2.5 – 4.0	8.0	9.0	1.6	2.9	2880	3790	301 751
		4.0 – 6.0	10.0	9.0	1.6	2.9	2880	3790	301 752
		6.0 – 8.0	12.0	9.0	1.6	2.9	2880	3790	301 753
		8.0 – 10.0	14.0	9.0	1.6	2.9	2880	3790	301 754
		10.0 – 12.0	16.0	9.0	1.6	2.9	2880	3790	301 755
		12.0 – 14.0	18.0	9.0	1.6	2.9	2880	3790	301 756
6.0	6.1	2.0 – 4.0	10.0	12.0	2.1	3.7	4200	5500	301 852
		4.0 – 6.0	12.0	12.0	2.1	3.7	4200	5500	301 853
		6.0 – 8.0	14.0	12.0	2.1	3.7	4200	5500	301 854
6.4	6.6	0.5 – 3.8	9.5	11.0	1.7	3.9	5000	6900	304 071
		3.8 – 7.6	13.0	11.0	1.7	3.9	5000	6900	304 072
		7.6 – 12.7	18.5	11.0	1.7	3.9	5000	6900	304 073
		12.7 – 15.9	22.0	12.7	1.8	3.9	5000	6400	304 074 ²
		15.9 – 19.1	25.1	12.7	1.8	3.9	5000	6400	304 075 ²
		19.1 – 25.4	31.5	12.7	1.8	3.9	5000	6400	304 076 ²

¹ Minimum based on rivet failure

² Rivet sleeve steel zinc plated, clear passivation; mandrel steel, phosphated

We reserve the right to amend specifications at any time.

Blind rivets

POP® Standard blind rivets

Large dome head

Material

Sleeve
Steel zinc, passivate
Melting point 1480 – 1510 °C

Mandrel
Steel zinc

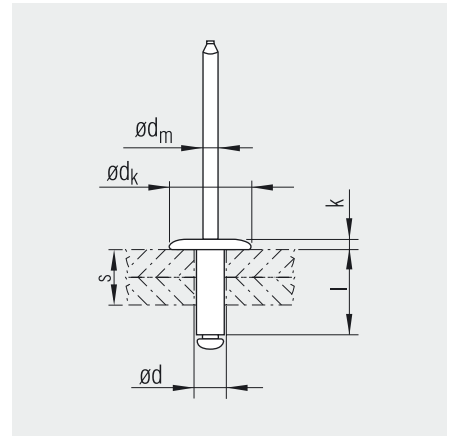

Nominal size- \varnothing d [mm]	Hole- \varnothing [mm]	Grip range s [mm]	Sleeve length l $+1.0$ -0.2 [mm]	Head		Mandrel \varnothing $d_{m\ nom}$ [mm]	Strength ¹ nominal		Part No.
				\varnothing $d_k \pm 0.3$ [mm]	Height $k \pm 0.2$ [mm]		Shear [N]	Tensile [N]	
3.2	3.3	1.6 – 3.2	6.2	9.5	1.4	1.9	1150	1550	306 011
		3.2 – 4.8	8.0	9.5	1.4	1.9	1150	1550	306 012
		4.8 – 6.4	9.8	9.5	1.4	1.9	1150	1550	306 013
		6.4 – 7.9	11.6	9.5	1.4	1.9	1150	1550	306 014
		7.9 – 9.5	13.4	9.5	1.4	1.9	1150	1550	306 015
4.0	4.1	3.2 – 4.8	8.5	12.0	1.6	2.3	1730	2500	306 032
		4.8 – 6.4	10.5	12.0	1.6	2.3	1730	2500	306 033
		6.4 – 7.9	12.2	12.0	1.6	2.3	1730	2500	306 034
		7.9 – 9.5	14.0	12.0	1.6	2.3	1730	2500	306 035
4.8	4.9	– 3.2	7.6	14.0	1.8	2.9	2620	3500	306 051
		3.2 – 4.8	9.3	14.0	1.8	2.9	2620	3500	306 052
		4.8 – 6.4	11.0	14.0	1.8	2.9	2620	3500	306 053
		6.4 – 7.9	12.7	14.0	1.8	2.9	2620	3500	306 054
		7.9 – 9.5	14.5	14.0	1.8	2.9	2620	3500	306 055
		9.5 – 11.1	16.5	14.0	1.8	2.9	2620	3500	306 056
		11.1 – 13.5	19.0	14.0	1.8	2.9	2620	3500	306 057
15.9 – 19.1	23.9	15.9	1.8	2.9	2620	3500	306 187 ²		

¹ Minimum based on rivet failure

² Rivet sleeve steel zinc plated, clear passivation; mandrel steel, phosphated

We reserve the right to amend specifications at any time.

POP® Standard blind rivets

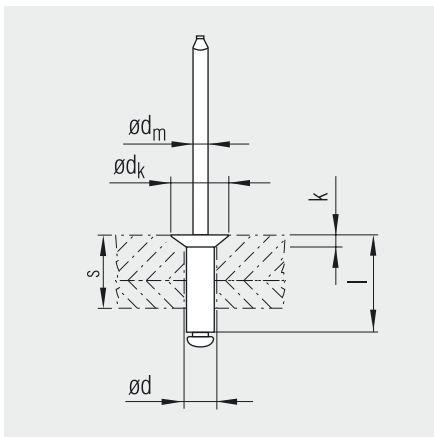

Countersunk head 120°

Material

- **Sleeve**
Steel zinc, passivate
Melting point 1480 – 1510 °C
- **Mandrel**
Steel zinc

Blind rivets

Nominal size- \varnothing d [mm]	Hole- \varnothing [mm]	Grip range s [mm]	Sleeve length $l \pm 0.3$ [mm]	Head		Mandrel \varnothing $d_{m \text{ nom}}$ [mm]	Strength ¹ nominal		Part No.
				\varnothing $d_k \pm 0.3$ [mm]	Height $k \pm 0.2$ [mm]		Shear [N]	Tensile [N]	
3.2	3.3	-2.7	5.4	6.5	1.1	1.9	1150	1550	304 720
		2.7 – 4.3	7.3	6.5	1.1	1.9	1150	1550	304 721
		4.3 – 5.8	9.0	6.5	1.1	1.9	1150	1550	304 722
		5.8 – 7.4	10.8	6.5	1.1	1.9	1150	1550	304 723
		7.4 – 9.0	12.6	6.5	1.1	1.9	1150	1550	304 724
		9.0 – 10.6	14.4	6.5	1.1	1.9	1150	1550	304 725
		10.6 – 12.2	16.1	6.5	1.1	1.9	1150	1550	304 726
4.0	4.1	2.9 – 4.5	8.5	8.0	1.5	2.3	1730	2500	304 741
		4.5 – 6.1	10.0	8.0	1.5	2.3	1730	2500	304 742
		6.1 – 7.7	12.0	8.0	1.5	2.3	1730	2500	304 743
		7.7 – 9.3	13.5	8.0	1.5	2.3	1730	2500	304 744
		9.3 – 10.9	15.5	8.0	1.5	2.3	1730	2500	304 745
		10.9 – 12.4	17.0	8.0	1.5	2.3	1730	2500	304 746
4.8	4.9	0.8 – 2.4	8.4	9.5	1.8	2.9	2620	3500	304 760
		2.4 – 4.8	9.3	9.5	1.8	2.9	2620	3500	304 761
		4.8 – 6.4	11.1	9.5	1.8	2.9	2620	3500	304 762
		6.4 – 7.9	12.8	9.5	1.8	2.9	2620	3500	304 763
		7.9 – 9.5	14.6	9.5	1.8	2.9	2620	3500	304 764
		9.5 – 11.1	16.4	9.5	1.8	2.9	2620	3500	304 765
		11.1 – 12.7	18.2	9.5	1.8	2.9	2620	3500	304 766
6.4	6.6	12.7 – 15.1	20.0	9.5	1.8	2.9	2620	3500	304 767
		0.3 – 3.8	9.5	10.9	1.6	3.9	4750	6500	304 081
		3.8 – 8.9	13.0	10.9	1.6	3.9	4750	6500	304 082
		8.9 – 13.5	18.5	10.9	1.6	3.9	4750	6500	304 083

¹ Minimum based on rivet failure

We reserve the right to amend specifications at any time.

POP® Standard blind rivets

Dome head

Material

Sleeve
Nickel/copper alloy 70/30
 zinc
 Melting point 1300 – 1350 °C

Mandrel
Steel zinc

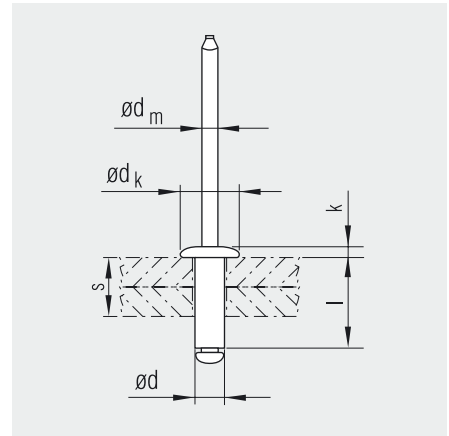

Nominal size- $\varnothing d$ [mm]	Hole- \varnothing [mm]	Grip range s [mm]	Sleeve length l $+1.0$ -0.2 [mm]	Head		Mandrel $\varnothing d_{m\ nom}$ [mm]	Strength ¹ nominal		Part No.
				$\varnothing d_k \pm 0.3$ [mm]	Height $k \pm 0.2$ [mm]		Shear [N]	Tensile [N]	
2.8	2.9	-1.8	5.0	4.9	0.7	1.8	1150	1300	304 210
		1.8 – 2.3	5.5	4.9	0.7	1.8	1150	1300	304 211
3.2	3.3	0.5 – 1.8	5.0	6.3	1.0	1.9	1750	2500	304 310
		1.8 – 3.1	6.0	6.3	1.0	1.9	1750	2500	304 311
		3.1 – 4.3	7.5	6.3	1.0	1.9	1750	2500	304 312
		4.3 – 5.8	9.0	6.3	1.0	1.9	1750	2500	304 313
		5.8 – 7.1	10.0	6.3	1.0	1.9	1750	2500	304 314
4.0	4.1	1.3 – 2.5	6.2	7.9	1.2	2.3	3000	4000	304 411
		2.5 – 4.1	7.8	7.9	1.2	2.3	3000	4000	304 412
		4.1 – 5.8	9.5	7.9	1.2	2.3	3000	4000	304 413
		5.8 – 6.6	10.3	7.9	1.2	2.3	3000	4000	304 414
		6.6 – 7.9	11.5	7.9	1.2	2.3	3000	4000	304 415
4.8	4.9	-2.3	6.0	8.1	1.2	2.9	3300	3750	304 510
		2.3 – 3.8	7.5	8.1	1.2	2.9	3300	3750	304 511
		3.8 – 5.1	9.0	8.1	1.2	2.9	3300	3750	304 512
		5.1 – 5.8	10.0	8.1	1.2	2.9	3300	3750	304 513
		5.8 – 8.6	12.5	8.1	1.2	2.9	3300	3750	304 514
		8.6 – 12.5	16.5	8.1	1.2	2.9	3300	3750	304 515
		12.5 – 15.0	19.0	8.1	1.2	2.9	3300	3750	304 516
		15.0 – 17.5	21.5	10.7	1.4	2.9	3300	3750	306 804
6.4	6.6	4.0 – 7.6	12.5	10.8	1.6	3.9	5400	6750	304 611
		8.0 – 12.7	18.0	10.8	1.6	3.9	5400	6750	304 612

¹ Minimum based on rivet failure

Countersunk head on request.

We reserve the right to amend specifications at any time.

POP® Standard blind rivets

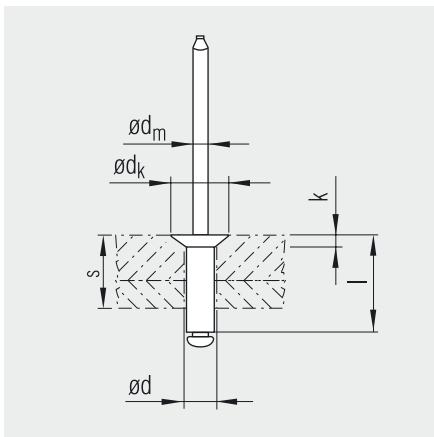

Countersunk head 120°

Material

Sleeve
Nickel/copper alloy 70/30
 zinc
 Melting point 1300 – 1350 °C

Mandrel
Steel zinc

Blind rivets

Nominal size- \varnothing d [mm]	Hole- \varnothing [mm]	Grip range s [mm]	Sleeve length l +1.0 -0.2 [mm]	Head		Mandrel \varnothing d _{m nom} [mm]	Strength ¹ nominal		Part No.
				\varnothing d _k ±0.3 [mm]	Height k ±0.2 [mm]		Shear [N]	Tensile [N]	
2.8	2.9	-2.3	5.5	4.9	0.8	1.8	1150	1300	304 220
		2.3 – 2.8	6.0	4.9	0.8	1.8	1150	1300	304 221
3.2	3.3	0.8 – 2.5	5.8	6.3	1.1	1.9	1750	2500	304 320
		2.5 – 3.8	7.0	6.3	1.1	1.9	1750	2500	304 321
		3.8 – 5.1	8.5	6.3	1.1	1.9	1750	2500	304 322
		5.1 – 6.6	10.0	6.3	1.1	1.9	1750	2500	304 323
		6.6 – 7.9	11.2	6.3	1.1	1.9	1750	2500	304 324
4.0	4.1	2.0 – 3.3	7.2	8.0	1.2	2.3	3000	4000	304 421
		3.3 – 4.8	8.7	8.0	1.2	2.3	3000	4000	304 422
		4.8 – 6.6	10.5	8.0	1.2	2.3	3000	4000	304 423
		6.6 – 7.4	11.3	8.0	1.2	2.3	3000	4000	304 424
		7.4 – 8.6	12.5	8.0	1.2	2.3	3000	4000	304 425
4.8	4.9	-4.6	9.0	8.1	1.4	2.9	3300	3750	304 521
		4.6 – 5.8	10.5	8.1	1.4	2.9	3300	3750	304 522
		5.8 – 6.6	11.0	8.1	1.4	2.9	3300	3750	304 523
		6.6 – 9.4	14.0	8.1	1.4	2.9	3300	3750	304 524
		9.4 – 13.2	18.0	8.1	1.4	2.9	3300	3750	304 525
		13.2 – 15.8	20.5	8.1	1.4	2.9	3300	3750	304 526
6.4	6.6	5.0 – 8.4	14.5	10.8	1.7	3.9	5400	6750	304 621
		8.4 – 13.5	19.4	10.8	1.7	3.9	5400	6750	304 622

¹ Minimum based on rivet failure

Countersunk head on request.

We reserve the right to amend specifications at any time.

POP® Standard blind rivets

Dome head

Material

Sleeve
Nickel/copper alloy 70/30
 zinc
 Melting point 1300 – 1350 °C

Mandrel
Stainless steel 1.4303

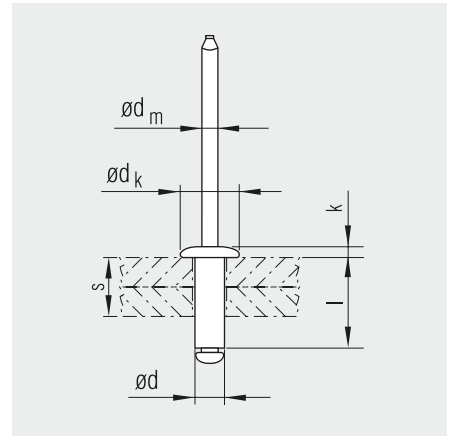

Nominal size- \varnothing d [mm]	Hole- \varnothing [mm]	Grip range s [mm]	Sleeve length l +1.0 -0.2 [mm]	Head		Mandrel \varnothing d _{m nom} [mm]	Strength ¹ nominal		Part No.
				\varnothing d _k ±0.3 [mm]	Height k ±0.2 [mm]		Shear [N]	Tensile [N]	
3.2	3.3	1.8 – 3.1	6.2	6.3	1.0	1.9	1750	2500	307 351
		3.1 – 4.3	7.5	6.3	1.0	1.9	1750	2500	307 352
		4.3 – 5.8	9.0	6.3	1.0	1.9	1750	2500	307 353
		5.8 – 7.1	10.3	6.3	1.0	1.9	1750	2500	307 354
4.0	4.1	1.3 – 2.5	6.2	7.9	1.2	2.3	3000	4000	307 411
		2.5 – 4.1	7.8	7.9	1.2	2.3	3000	4000	307 412
		4.1 – 5.8	9.5	7.9	1.2	2.3	3000	4000	307 413
		5.8 – 6.6	10.3	7.9	1.2	2.3	3000	4000	307 414
		6.6 – 7.9	11.5	7.9	1.2	2.3	3000	4000	307 415
4.8	4.9	– 2.3	6.2	8.1	1.2	2.9	3300	3750	307 510
		2.3 – 3.8	7.7	8.1	1.2	2.9	3300	3750	307 511
		3.8 – 5.1	9.3	8.1	1.2	2.9	3300	3750	307 512
		5.1 – 5.8	10.0	8.1	1.2	2.9	3300	3750	307 513
		5.8 – 8.6	12.8	8.1	1.2	2.9	3300	3750	307 514
		8.6 – 12.4	16.5	8.1	1.2	2.9	3300	3750	307 515
		12.5 – 15.0	19.0	8.1	1.2	2.9	3300	3750	307 516

¹ Minimum based on rivet failure

We reserve the right to amend specifications at any time.

POP® Standard blind rivets

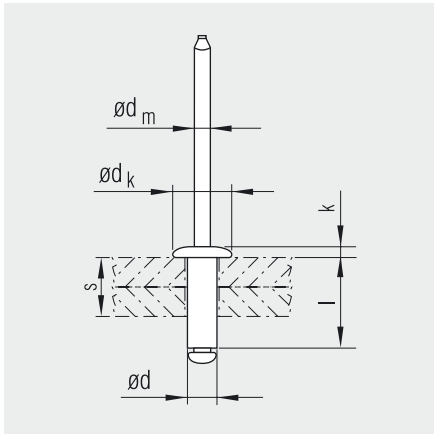

Dome head

Material

■ **Sleeve**
Stainless steel 1.4303
 Melting point 1480 – 1510 °C

■ **Mandrel**
Stainless steel 1.4541



Nominal size- \varnothing d [mm]	Hole- \varnothing [mm]	Grip range s [mm]	Sleeve length l +1.0 -0.2 [mm]	Head		Mandrel \varnothing d _{m nom} [mm]	Strength ¹ nominal		Part No.
				\varnothing d _{k ±0.3} [mm]	Height k ±0.2 [mm]		Shear [N]	Tensile [N]	
3.2	3.3	1.6 – 3.2	6.4	6.4	1.0	1.9	2400	3000	303 311
		3.2 – 4.8	8.0	6.4	1.0	1.9	2400	3000	303 312
		4.8 – 6.4	9.5	6.4	1.0	1.9	2400	3000	303 313
		6.4 – 9.5	12.7	6.4	1.0	1.9	2400	3000	303 314
		9.5 – 12.7	15.9	6.4	1.0	1.9	2400	3000	303 315
4.0	4.1	1.6 – 3.2	7.0	8.0	1.1	2.4	4000	5000	303 411
		3.2 – 6.4	10.2	8.0	1.1	2.4	4000	5000	303 412
		6.4 – 9.5	13.3	8.0	1.1	2.4	4000	5000	303 413
4.8	4.9	1.6 – 3.2	7.6	9.5	1.3	2.9	4400	6100	303 511
		3.2 – 6.4	10.8	9.5	1.3	2.9	4400	6100	303 512
		6.4 – 9.5	14.0	9.5	1.3	2.9	4400	6100	303 513
		9.5 – 12.7	17.2	9.5	1.3	2.9	4400	6100	303 514

¹ Minimum based on rivet failure

On request: • Large dome head
 • Countersunk head

We reserve the right to amend specifications at any time.

POP® Standard blind rivets

Dome head

Material

Sleeve
Copper
 Melting point 1080 °C

Mandrel
Steel zinc

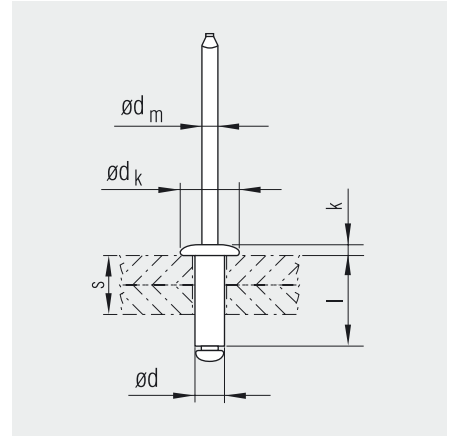

Nominal size- \varnothing d [mm]	Hole- \varnothing [mm]	Grip range s [mm]	Sleeve length l +1.0 -0.2 [mm]	Head		Mandrel \varnothing $d_{m\ nom}$ [mm]	Strength ¹ nominal		Part No.
				\varnothing $d_k \pm 0.3$ [mm]	Height $k \pm 0.2$ [mm]		Shear [N]	Tensile [N]	
3.2	3.3	-1.3	4.5	6.4	1.0	1.8	800	1200	304 970
		2.1 – 2.9	6.3	6.4	1.0	1.8	800	1200	304 971
		2.9 – 4.5	8.0	6.4	1.0	1.8	800	1200	304 972
4.0	4.1	-3.2	7.0	8.0	1.2	2.3	1330	1910	304 961
		3.2 – 6.4	10.5	8.0	1.2	2.3	1330	1910	304 963
		6.4 – 9.5	14.5	8.0	1.2	2.3	1330	1910	304 965

¹ Minimum based on rivet failure

We reserve the right to amend specifications at any time.

POP® Standard blind rivets

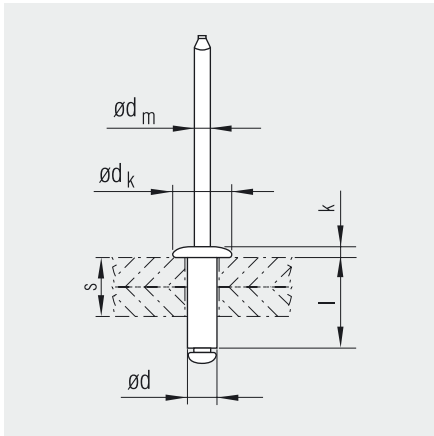

Dome head

Material

Sleeve
Copper
Melting point 1080 °C

Mandrel
Bronze

Nominal size- $\varnothing d$ [mm]	Hole- \varnothing [mm]	Grip range s [mm]	Sleeve length l $+1.0$ -0.2 [mm]	Head		Mandrel $\varnothing d_{m\ nom}$ [mm]	Strength ¹ nominal		Part No.
				$\varnothing d_k \pm 0.3$ [mm]	Height $k \pm 0.2$ [mm]		Shear [N]	Tensile [N]	
3.2	3.3	0.5 – 1.3	4.5	6.4	1.0	1.8	800	1200	304 870
		2.1 – 2.9	6.3	6.4	1.0	1.8	800	1200	304 871
		2.9 – 4.5	8.0	6.4	1.0	1.8	800	1200	304 872
4.0	4.1	– 3.2	7.0	8.0	1.2	2.3	1330	1910	304 861
		3.2 – 6.4	10.5	8.0	1.2	2.3	1330	1910	304 863
		6.5 – 9.5	14.5	8.0	1.2	2.3	1330	1910	304 865

¹ Minimum based on rivet failure

We reserve the right to amend specifications at any time.

NOTES

